



PARTS LIST

**FUJI INDUSTRIAL**  
FILM PROCESSOR

**FPM6000SP**

**First Edition**

IX-60-PAE

## USE OF PARTS LISTS AND EXPLODED VIEW ILLUSTRATIONS

---

- The necessary replacement part should be sought from the exploded drawing of the pertinent section of the instrument. Remember that the exploded view parts that are shaded  can only be supplied as unitized blocks.
- The exploded drawing numbers correspond to the drawing reference numbers in the parts lists on the page opposite.
- From the parts list record the part number and the part name.
- When ordering parts, not only the part number and name, but also the instrument name and serial number should be provided.
- Improved part substitutions will in certain instances result in part number changes without prior notice.

**NOTE:** *The numbers indicated in the parts list "Qty" column indicate the quantity of the designated part incorporated in a single instrument. However, for reference ease some parts may appear twice or more in the parts lists.*

---

### **CAUTION**

The Parts List is intended for exclusive use by technical service personnel authorized by Fuji Photo Film Co., Ltd. (including personnel to whom technical servicing is commissioned by Fuji Photo Film Co., Ltd.) and is included alone or together the operation and service manuals in one combined volume in each packing of equipment.

To avoid possible electric shock or other personal injury, anyone else but the authorized technical service personnel must in no case be allowed to attempt to gain access to the interior of the equipment by screwing the cover or other parts off, using the Parts List as a guide.

Use of the Parts List by anyone else but the authorized technical service personnel should be forbidden.

# STANDARD MARKING SYSTEM CHART FOR METAL FASTENINGS

These screws, bolts and nuts are ISO metric coarse screw thread.

DRAWING REFERENCE NO.	PART NAME	SYMBOL	PART NO. (EXAMPLE)	SYMBOL USED IN FIG. (EXAMPLE)	NOTE	SHAPE
1	Screw, flat head	S	301S7000310	*S3×10	M3×10	1.
2	Screw, pan head	N	301S1000310	*N3×10	M3×10	2.
3	Screw, truss head	T	301S3000310	*T3×10	M3×10	3.
4	Screw, tapping, flat head	STa	306S1000310	*STa3×10	M3×10	4.
5	Screw, tapping, pan head	NTa	306S3000310	*NTa3×10	M3×10	5.
6	Screw, tapping, truss head	TTa	306SF000310	*TTa3×10	M3×10	6.
7	Setscrew hex socket head (cup point)	PK	303S2000310	*PK3×10	M3×10	7.
8	Setscrew hex socket head (cone point)	PT	303S3000310	*PT3×10	M3×10	8.
9	Setscrew hex socket head (flat point)	PH	303S1000310	*PH3×10	M3×10	9.
10	Setscrew slotted head (cup point)	FK	302S2000305	*FK3×5	M3×5	10.
11	Setscrew slotted head (cone point)	FT	302S3000305	*FT3×5	M3×5	11.
12	Setscrew slotted head (flat point)	FH	302S1000305	*FH3×5	M3×5	12.
13	Bolt, hex head	R	304S1000310	*R3×10	M3×10	13.
14	Bolt, hex socket head	Q	304S3000410	*Q4×10	M4×10	14.
15	Nut, hex	Na	305S1120003	Na 3	M3	15.
16	Washer, plain	W	309S0110003	*W3	M3	16.
17	Washer, spring	SW	309S0220003	*SW3	M3	17.
18	E-ring	E	315S3000030	*E3	Nominal diam. M3	18.
19	External ring	CG	315S1000030	*CG3	Nominal diam. M3	19.
20	Internal ring	CA	315S2000030	*CA3	Nominal diam. M3	20.
21	Plastic washer	CP	309S019203	CP3	Nominal diam. M3	21.
22	Plastic ring	KP	315S192030	KP3	Nominal diam. M3	22.
23	Screw, sems	A	308S1000310	A3×10	M3×10, with flat and spring washer	23.
24	Screw, double sems	B	308S2000310	B3×10		24.

### ● MATERIAL INDICATING MARK

MATERIAL	MARK ADDED TO PART SYMBOL	EXAMPLE	MATERIAL CODE
Iron chromate	Not used	N3	11
SUS304	*	*N3	00
SUS316	**	**N3	05
Titanium	** *	** *N3	80
Iron nickel	Shape-indicating symbol enclosed in a circle	(N3)	10
Iron (black oxide coating)	Shape-indicating symbol enclosed in a square	[N3]	12
Brass nickel	Shape-indicating symbol enclosed in a triangle	△N3	55
Plastic	●	●CP	92

### ● DECIPHERING THE IDENTIFICATION MARKINGS OF METAL FASTENINGS

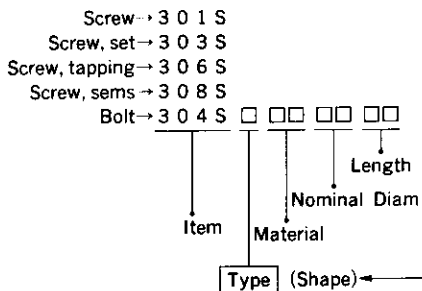
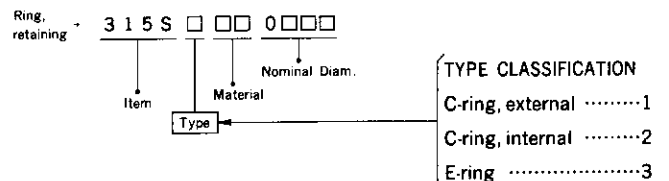
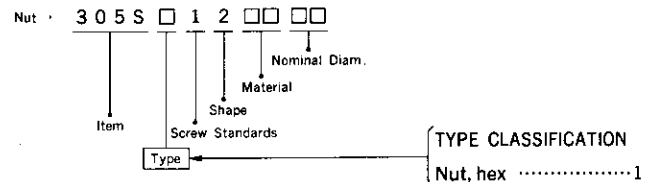
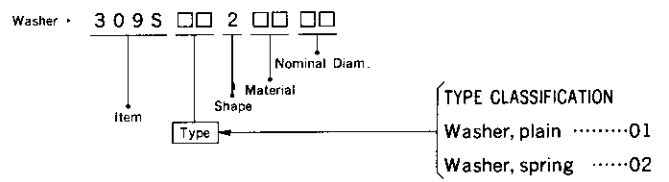

- TYPE (SHAPE) CLASSIFICATION
- Screw, pan head .....1
  - Screw, flat head .....7
  - Screw, tapping, flat head .....3~4
  - Screw, tapping, pan head .....1~2
  - Screw, tapping, truss head...F~H
  - Screw, truss head .....3
  - Setscrew, hex head (flat) ...1
  - Setscrew, hex head (cup point) .....2
  - Setscrew, hex head (cone) ...3
  - Bolt, hex .....1
  - Bolt, hex .....2
  - Bolt, hex socket head ...3
  - Screw, sems .....1
  - Screw, double sems ...2

## INDEX 01

● Body Frame (1)

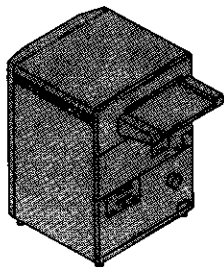

## INDEX 02

● Developer Rack

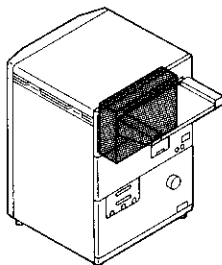

## INDEX 03

● Fixer Rack

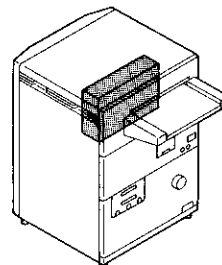

## INDEX 04

● Wash Rack

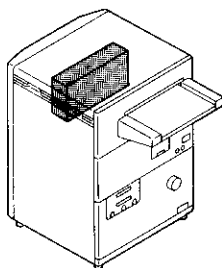

## INDEX 05

● Entrance/Crossover Racks

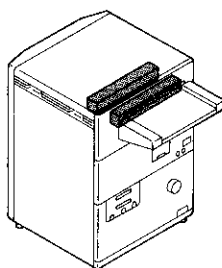

## INDEX 06

● Crossover/Squeegee Racks

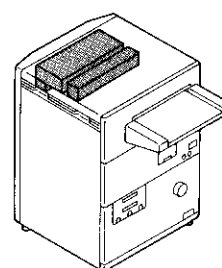

## INDEX 07

● Drive/Processing Sections

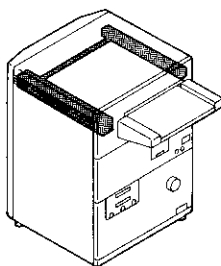

## INDEX 08

● Processing Section

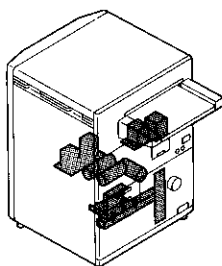

## INDEX 09

● Piping Section

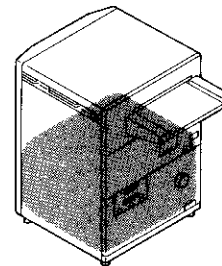

## INDEX 10

● Dryer Rack (1)

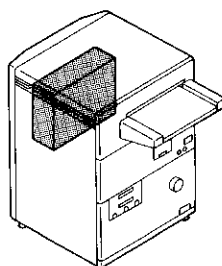

## INDEX 11

● Dryer Rack (2)

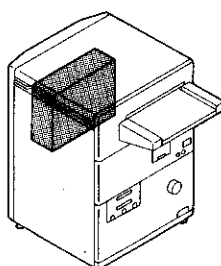

## INDEX 12

● Dryer Fan Section

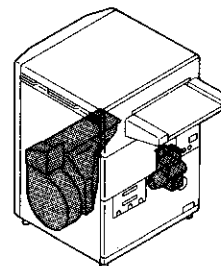

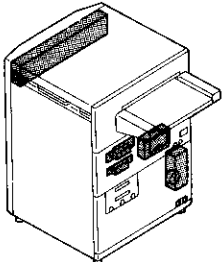
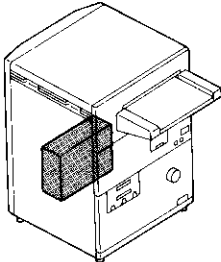
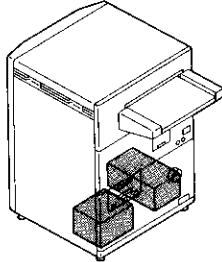
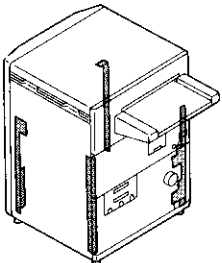
<p><b>INDEX 13</b> ● Control Section (1)</p> 	<p><b>INDEX 14</b> ● Control Section (2)</p> 	<p><b>INDEX 15</b> ● Control Section (3)</p> 
<p><b>INDEX 16</b> ● Body Frame (2)</p> 	<p><b>INDEX 17</b> ● FPM6000SP Part No.Index List</p>	

● The parts shown in the shaded area of each index illustration are described in the page or pages having the same index number.



## ● BODY FRAME

## Drawing

Ref. No.	Part No.	Part Name	Qty	Remarks
1	358F0375B	Receiver	1	
2	356F3625	Bracket	2	
3	350H0138	Cover	1	
4	350F3075A	Cover	1	
5	350F2321	Cover	1	
6	394F0012	Magnet	2	NIHON AUTO RS-A
7	356F7682A	Bracket	2	
8	355F1325	Frame	1	
9	350F4345	Cover	1	
10	362F1142A	Support	2	
11	347F1462	Spacer	6	
12	382F0517A	Tape, adhesive	1	450mm
13	405F6944	Label	2	No watering
14	136H1528	Cable	4	
15	356F7738	Bracket	1	
16	128F9707	Switch	2	
17	382F0130-M002	Tape, sponge	1	t3xW10x $\phi$ 35
18	356F7729A	Bracket	1	
19	350F3020A	Cover	1	
20	113F0647A	PCB ass'y	1	
21	350F4728	Cover	1	
22	356F8348	Bracket	4	
23	356F4895A	Bracket	1	
24	363F2251A-BF	Guide	1	
25	356F4896	Bracket	1	
26	350F4704	Cover	1	
27	363F2337A-BF	Guide	1	
28	317F0078	Cap	2	
29	405F8319228	Label	1	
30	405F8319229	Label	2	
31	405F8319224	Label	1	
32	405F8319222	Label	1	
33	394F0050	Magnet	2	TAKIGEN C-200-4
34	405S0061	Label	3	
35	350F3028A	Cover	1	
36	362F0660	Support	2	
37	350F3914	Cover	1	
38	350F3026A	Cover	1	
39	405F8319228	Label	1	
40	405F8319229	Label	2	
41	405F8319223	Label	1	

## Drawing

Ref. No.	Part No.	Part Name	Qty	Remarks
42	369F0214	Duct	1	
43	356F7923	Bracket	2	
44	356F7728	Bracket	2	
45	350F4728	Cover	2	
46	357H0029D	Mount	1	
47	367F0071	Foot	4	KONOE D-8 M12X120
48	350F3915	Cover	1	
49	362F0657	Support	1	
50	316S3030	Catch	5	TAKIGEN C-54-1
51	347F0717A	Spacer	6	
52	356F7939A	Bracket	1	
53	136H1528	Cable	4	
54	356F8348	Bracket	4	
55	387F0055	Device, antistatic	1	
56	345F1660A	Plate, shield	1	
57	363F3054	Guide	1	
58	356F5037A	Bracket	1	
59	363F3053A-BF	Guide	1	
60	322F2087	Support, shaft	2	OIRESU 80F-0405
61	317F1120	Cap	1	
62	405F0675	Label	1	
63	405F7374	Label	1	
64	405N0187	Label	3	
65	405F7345	Label	1	
66	382F0046-M002	Tape, sponge	2	S60BST (Black) t5xW7x $\phi$ 150
67	405S0061	Label	3	
68	356F7695	Bracket	2	
69	369F0365	Tube	2	
70	356F7023A	Bracket	2	
71	405F7954	Plate, rating	1	TUV 1 $\phi$
72	405F8176	Plate, rating	1	UL
73	405F7955	Plate, rating	1	TUV 3 $\phi$ 4W
74	405F7346	Label	1	UL
75	345F1909	Plate, shield	1	
76	345F1910	Plate, shield	1	
77	345F1908	Plate, shield	1	
78	305F0050	Nut	4	
①	350H0096	Cover	1	Lid ass'y

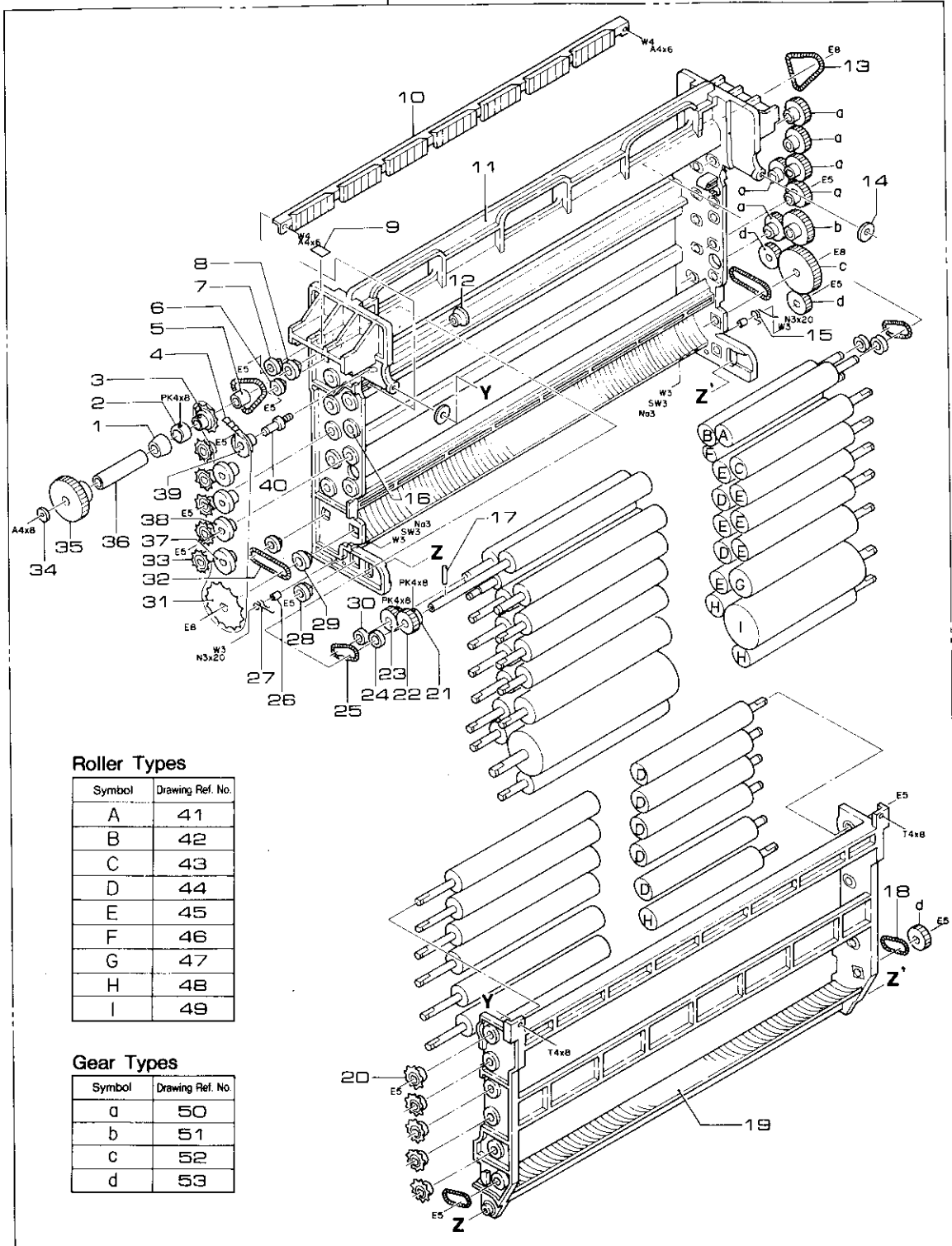
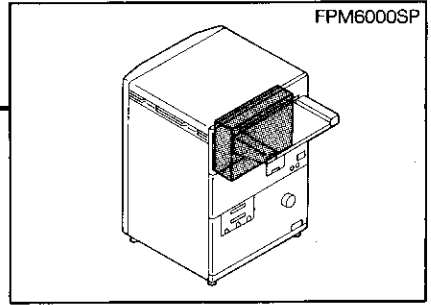

### Roller Types

Symbol	Drawing Ref. No.
A	41
B	42
C	43
D	44
E	45
F	46
G	47
H	48
I	49

### Gear Types

Symbol	Drawing Ref. No.
a	50
b	51
c	52
d	53



## ● DEVELOPER RACK

Drawing					Drawing				
Ref. No.	Part No.	Part Name	Qty	Remarks	Ref. No.	Part No.	Part Name	Qty	Remarks
1	335F6791522	Flange	3		28	322FC084	Support, shaft	51	
2	338S0010	Ring	35		29	322FC286	Support, shaft	6	
3	326F8344181A	Wheel, ladder chain	3		30	362F1091	Support	6	
4	325FQ305068	Chain, ladder	1	68 links	31	326F3031801	Wheel, ladder chain	3	
5	347F0927	Spacer	3		32	388F2150A	Spring, tension	8	
6	322FC052	Support, shaft	6		33	326F3030902	Wheel, ladder chain	22	
7	322FC084	Support, shaft	51		34	309F0070	Washer	6	
8	322FC162	Support, shaft	15		35	327F2202005A	Gear, helical	3	
9	405F8319231	Label	3		36	338F0681	Collar	3	
10	363F3056	Guide	3		37	337F0025	Wheel	3	
11	349F0611	Plate, rack side	1		38	337F0026	Wheel	5	
12	305F0165	Nut	3		39	337F0027	Wheel	3	
13	388F2150A	Spring, tension	8		40	319F3769	Shaft	3	
14	309F0050	Washer, plastic	7	TOCHIGIYA TM-147 No.2	41	334F3652	Roller, rubber	1	
15	388F3085	Spring, torsion	3		42	334F2957	Roller, resin	1	
16	322FC205A	Support, shaft	80		43	334F2961	Roller, resin	7	
17	310F1002018	Pin, straight	7	TAIYOH SP	44	334F2960	Roller, resin	1	
18	388F2146A	Spring, tension	10		45	334F2962	Roller, resin	6	
19	349F0612	Plate, rack side	1		46	334F3562	Roller, rubber	1	
20	326F3030902	Wheel, ladder chain	22		47	334F2958	Roller, resin	1	
21	338S0010	Ring	35		48	334F3418	Roller, rubber	3	
22	327F1122039	Gear, spur	4		49	334F2959	Roller, resin	1	
23	327F1122031A	Gear, spur	3		50	327F1151904	Gear, spur	16	
24	362F1090	Support	6		51	327F1152008	Gear, spur	3	
25	388F2147A	Spring, tension	14		52	327F1124008	Gear, spur	3	
26	347F0704	Spacer	6		53	327F1122035	Gear, spur	13	
27	388F3084	Spring, torsion	3		①	802H0348	Developer rack ass'y	1	

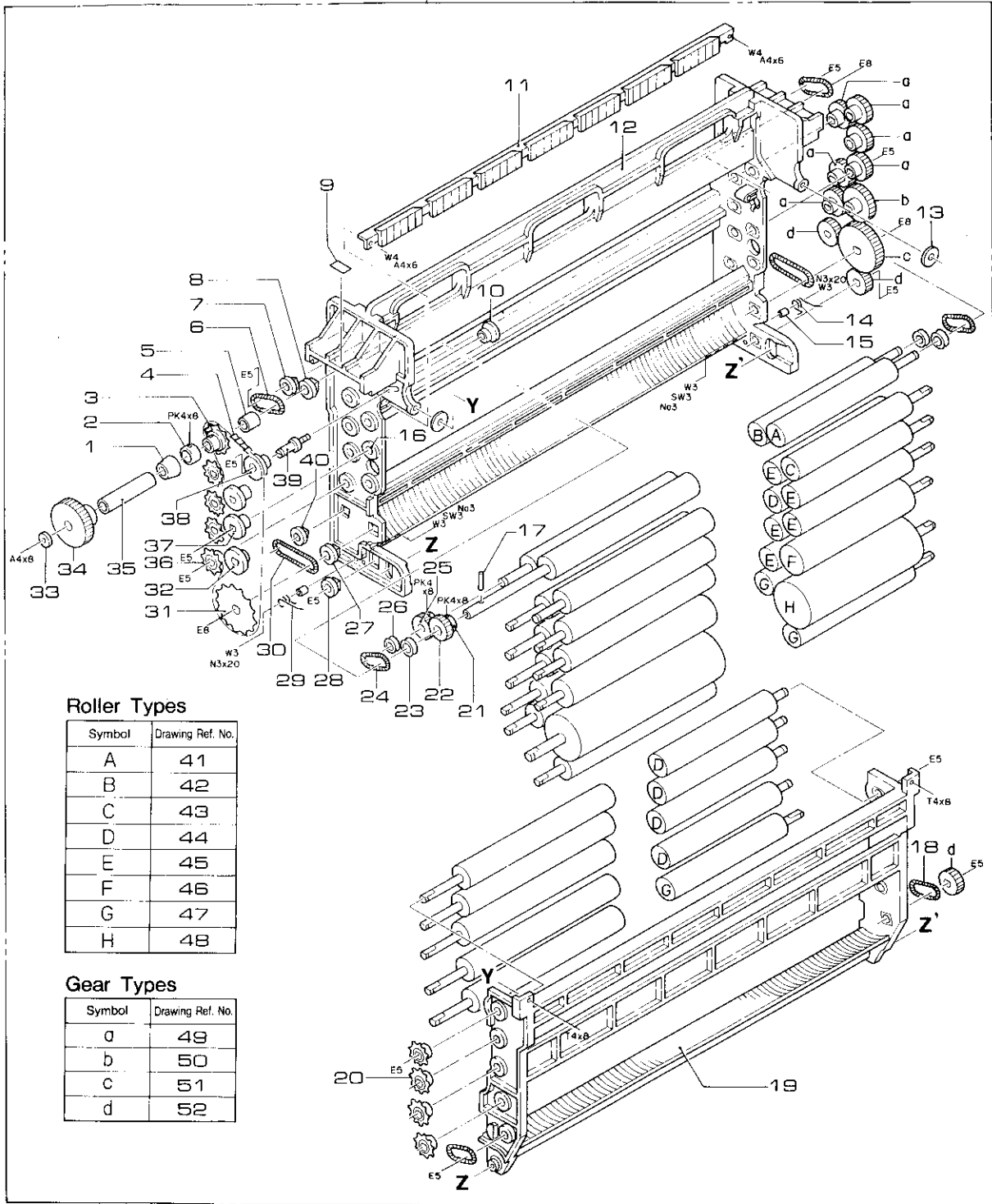
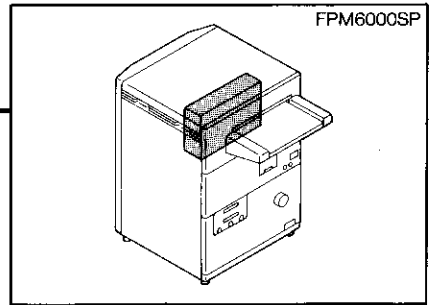

### Roller Types

Symbol	Drawing Ref. No.
A	41
B	42
C	43
D	44
E	45
F	46
G	47
H	48

### Gear Types

Symbol	Drawing Ref. No.
a	49
b	50
c	51
d	52

## ● FIXER RACK

## Drawing

Ref. No.	Part No.	Part Name	Qty	Remarks
1	335F6791522	Flange	3	
2	338S0010	Ring	35	
3	326F8344181A	Wheel, ladder chain	3	
4	325FQ305061	Chain, ladder	1	61 links
5	347F0927	Spacer	3	
6	388F2147A	Spring, tension	14	
7	322FC084	Support, shaft	51	
8	322FC162	Support, shaft	15	
9	405F8319232	Label	3	
10	305F0165	Nut	3	
11	363F3056	Guide	3	
12	349F0613	Plate, rack side	1	
13	309F0050	Washer, plastic	7	TOCHIGIYA TM-147 No. 2
14	388F3085	Spring, torsion	3	
15	347F0704	Spacer	6	
16	322FC205A	Support, shaft	80	
17	310F1002018	Pin, straight	7	TAIYOH SP
18	388F2146A	Spring, tension	10	
19	349F0614	Plate, rack side	1	
20	326F3030902	Wheel, ladder chain	22	
21	338S0010	Ring	35	
22	327F1122039	Gear, spur	4	
23	362F1090	Support	6	
24	388F2147A	Spring, tension	14	
25	327F1122031A	Gear, spur	3	
26	362F1091	Support	6	
27	322FC286	Support, shaft	6	

## Drawing

Ref. No.	Part No.	Part Name	Qty	Remarks
28	322FC084	Support, shaft	51	
29	388F3084	Spring, torsion	3	
30	388F2150A	Spring, tension	8	
31	326F3031801	Wheel, ladder chain	3	
32	337F0025	Wheel	3	
33	309F0070	Washer	6	
34	327F2202005A	Gear, helical	3	
35	338F0681	Collar	3	
36	326F3030902	Wheel, ladder chain	22	
37	337F0026	Wheel	5	
38	337F0027	Wheel	3	
39	319F3769	Shaft	3	
40	322FC084	Support, shaft	51	
41	334F3527B	Roller, rubber	1	
42	334F2710B	Roller, resin	3	
43	334F2713B	Roller, resin	3	
44	334F2712B	Roller, resin	14	
45	334F2711B	Roller, resin	13	
46	334F2699B	Roller, resin	3	
47	334F2782	Roller, resin	6	
48	334F2698B	Roller, resin	3	
49	327F1151904	Gear, spur	16	
50	327F1152008	Gear, spur	3	
51	327F1124008	Gear, spur	3	
52	327F1122035	Gear, spur	13	
①	802H0181B	Fixer rack ass'y	1	

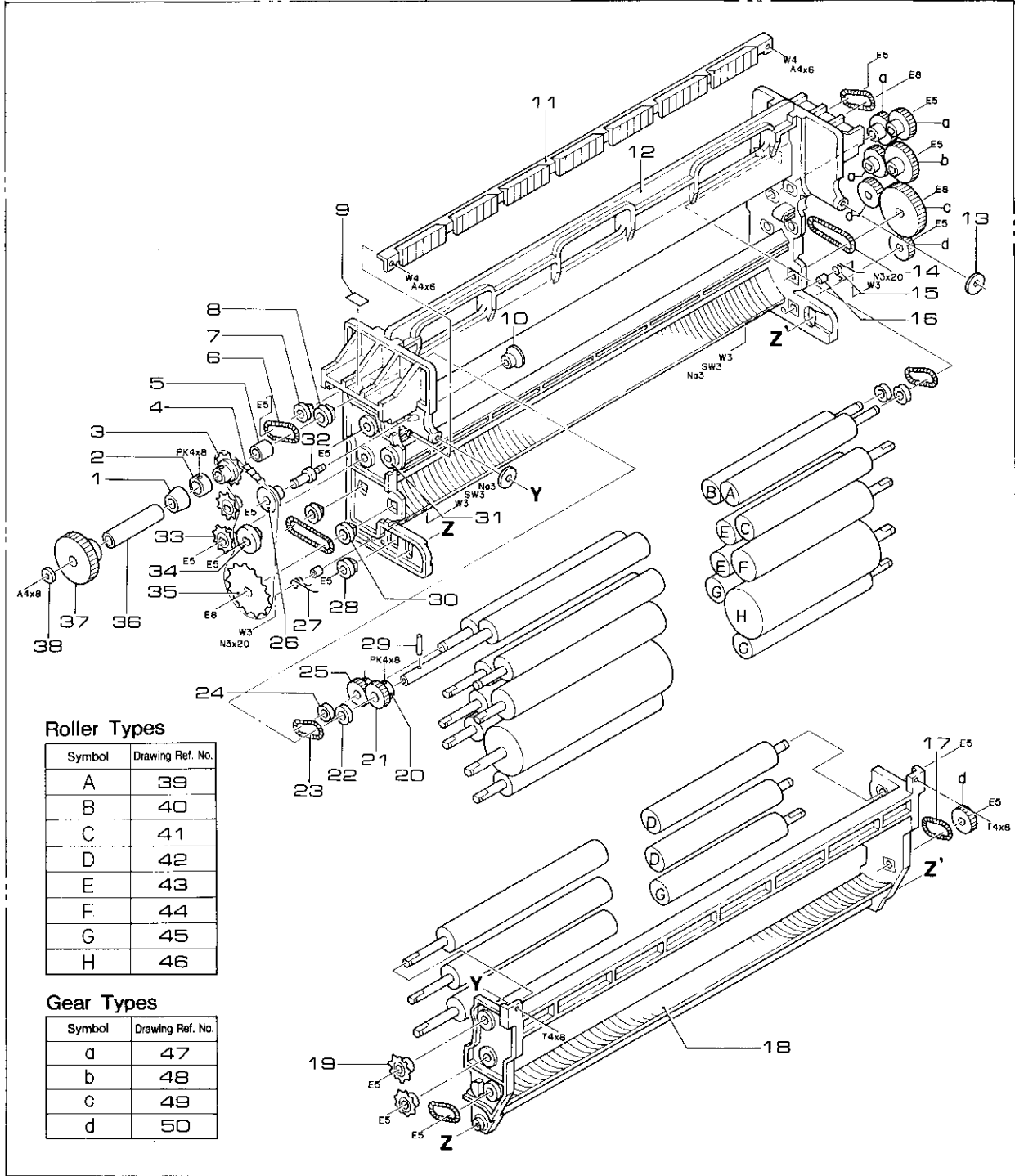
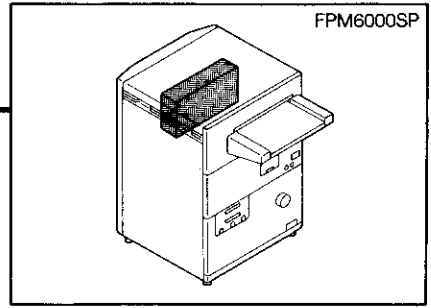

### Roller Types

Symbol	Drawing Ref. No.
A	39
B	40
C	41
D	42
E	43
F	44
G	45
H	46

### Gear Types

Symbol	Drawing Ref. No.
a	47
b	48
c	49
d	50

## ● WASH RACK

Drawing				Drawing					
Ref. No.	Part No.	Part Name	Qty	Remarks	Ref. No.	Part No.	Part Name	Qty	Remarks
1	335F6791522	Flange	3		27	388F3084	Spring, torsion	3	
2	338S0010	Ring	35		28	322FC084	Support, shaft	51	
3	326F8344181A	Wheel, ladder chain	3		29	310F1002018	Pin, straight	7	TAIYOH SP
4	325FQ305046	Chain, ladder	1	46 links	30	322FC286	Support, shaft	6	
5	347F0927	Spacer	3		31	322FC205A	Support, shaft	80	
6	388F2147A	Spring, tension	14		32	319F3769	Shaft	3	
7	322FC084	Support, shaft	51		33	326F3030902	Wheel, ladder chain	22	
8	322FC162	Support, shaft	15		34	337F0025	Wheel	3	
9	405F8319233	Label	2		35	326F3031801	Wheel, ladder chain	3	
10	305F0165	Nut	3		36	338F0681	Collar	3	
11	363F3056	Guide	3		37	327F2202005A	Gear, helical	3	
12	349F0615	Plate, rack side	1		38	309F0070	Washer	6	
13	309F0050	Washer, plastic	7	TOCHIGIYA TM-147 No. 2	39	334F3528A	Roller, rubber	1	
14	388F2150A	Spring, tension	8		40	334F2710B	Roller, resin	3	
15	388F3085	Spring, torsion	3		41	334F2713B	Roller, resin	3	
16	347F0704	Spacer	6		42	334F2712B	Roller, resin	14	
17	388F2146A	Spring, tension	10		43	334F2711B	Roller, resin	13	
18	349F0616	Plate, rack side	1		44	334F2699B	Roller, resin	3	
19	326F3030902	Wheel, ladder chain	22		45	334F2782	Roller, resin	6	
20	338S0010	Ring	35		46	334F2698B	Roller, resin	3	
21	327F1122039	Gear, spur	4		47	327F1151904	Roller, resin	16	
22	362F1090	Support	6		48	327F1152008	Roller, resin	3	
23	388F2147A	Spring, tension	14		49	327F1124008	Roller, resin	3	
24	362F1091	Support	6		50	327F1122035	Roller, resin	13	
25	327F1122031A	Gear, spur	3		①	802H0182B	Wash rack ass'y	1	
26	337F0027	Wheel	3						

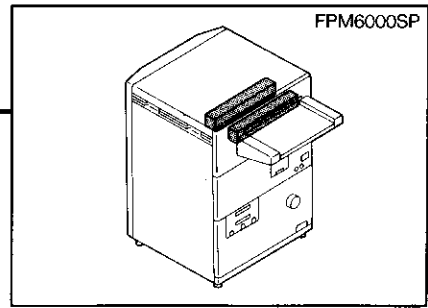

1 Entrance Rack

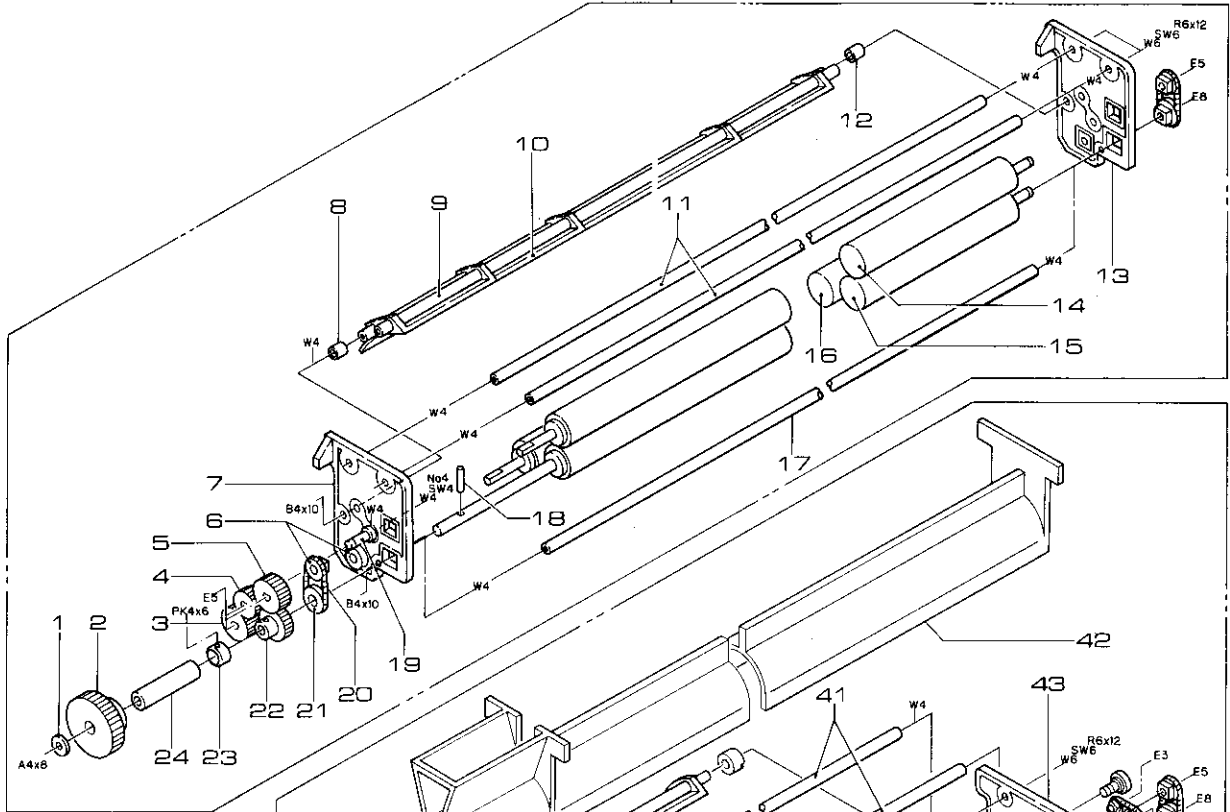

2

D-F Crossover Rack

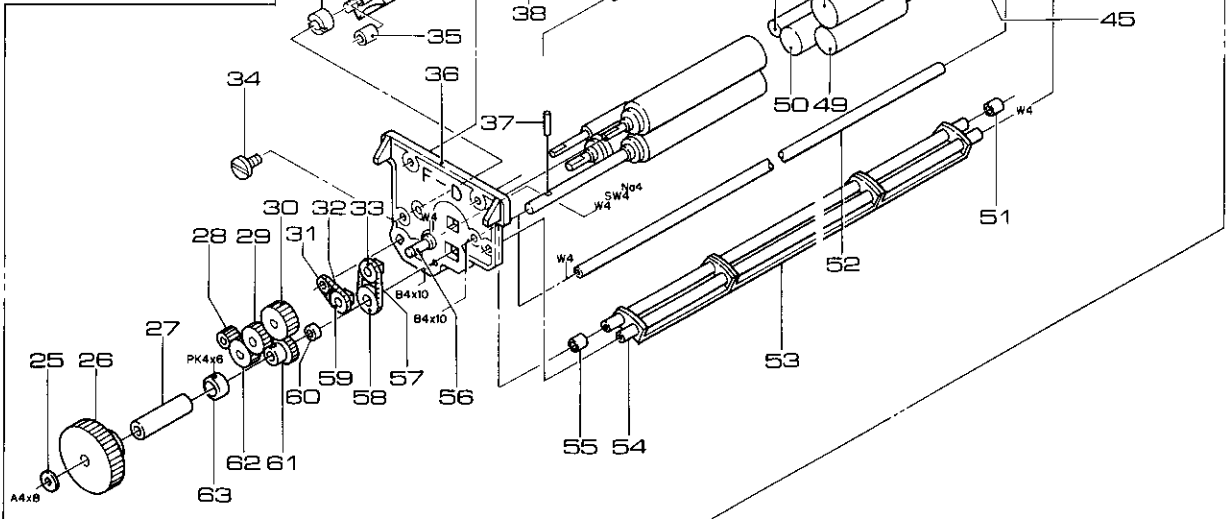

● ENTRANCE/CROSSOVER RACKS

Drawing				Drawing					
Ref. No.	Part No.	Part Name	Qty	Remarks	Ref. No.	Part No.	Part Name	Qty	Remarks
1	309F0070	Washer	6		35	347F0925	Spacer	11	
2	327F2202004A	Gear, helical	1		36	349F0530B	Plate, rack side	1	
3	327F1122035	Gear, spur	13		37	310F1002018	Pin, straight	7	
4	327F1121617	Gear, spur	1		38	363F2872	Guide	7	
5	327F1122035	Gear, spur	13		39	347F1590	Spacer	4	
6	322FC084	Support, shaft	51		40	313F0576B	Stay	18	
7	349F0527B	Plate, rack side	2		41	313F0575B	Stay	9	
8	347F0925	Spacer	11		42	363F3664	Guide	2	
9	313F0576B	Stay	18		43	349F0531B	Plate, rack side	1	
10	363F1609	Plate, guide	7		44	335F0088	Flange	8	
11	313F0575B	Stay	9		45	335F0089	Flange	4	
12	347F0924	Spacer	7		46	335F0090	Flange	2	
13	349F0527B	Plate, rack side	2		47	334F2736	Roller, resin	1	
14	334F2736	Roller, resin	1		48	334F1155B	Roller	1	
15	334F3525A	Roller, rubber	1		49	334F3651	Roller, rubber	1	
16	334F2694B	Roller, resin	1		50	334F3563	Roller, rubber	1	
17	313F0576B	Stay	18		51	347F0924	Spacer	7	
18	310F1002018	Pin, straight	7	Diam. 2 ∅ 18	52	313F0797	Stay	2	
19	319F2785	Shaft	1		53	363F3661	Guide	14	
20	388F2147A	Spring, tension	14		54	313F0576B	Stay	18	
21	322FC162	Support, shaft	15		55	347F0925	Spacer	11	
22	327F1122039	Gear, spur	4		56	319F2786	Shaft	2	
23	338S0010	Ring	35		57	388F2148A	Spring, tension	16	
24	338F0680	Collar	3		58	322FC162	Support, shaft	15	
25	309F0070	Washer	6		59	322FC052	Support, shaft	6	
26	327F2202401	Gear, helical	1		60	338F0234	Collar	2	
27	338F0680	Collar	3		61	327F1102020	Gear, spur	1	
28	327F1101002	Gear, spur	1		62	327F1102015	Gear, spur	1	
29	327F1102008	Gear, spur	1		63	338S0010	Ring	35	
30	327F1102507	Gear, spur	1						
31	322FC051	Support, shaft	2		①	802H0183A	Entrance rack ass'y		
32	388F2146A	Spring, tension	10		②	802H0349	D-F crossover rack ass'y		
33	322FC084	Support, shaft	51						
34	308F0325	Screw, special	4						

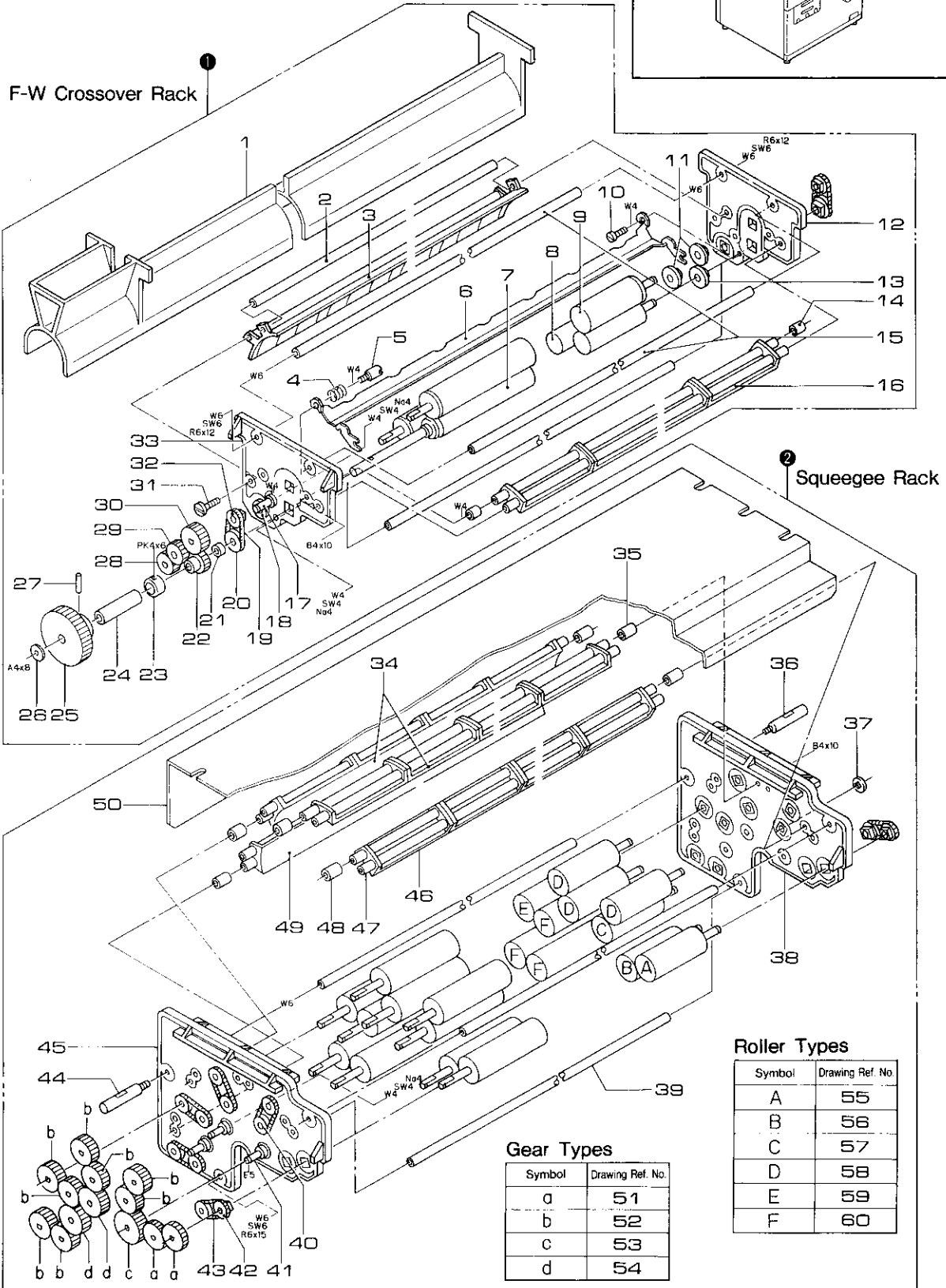
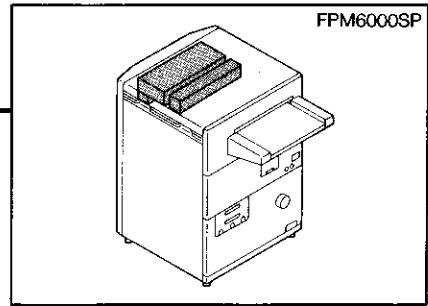



## ● CROSSOVER/SQUEEGEE RACKS

Drawing				Drawing					
Ref. No.	Part No.	Part Name	Qty	Remarks	Ref. No.	Part No.	Part Name	Qty	Remarks
1	3 6 3 F 3 6 6 4	Guide	2		34	3 6 3 F 2 1 8 9	Guide	28	
2	3 1 3 F 0 5 7 6 B	Stay	18		35	3 4 7 F 0 9 2 4	Spacer	7	
3	3 6 3 F 4 3 8 0	Guide	1		36	3 1 9 F 3 7 7 0	Shaft	2	
4	3 8 8 F 4 0 1 9	Spring, spiral	1		37	3 4 6 F 0 9 8 0	Plate, auxiliary	1	
5	3 1 9 F 3 6 1 0 A	Shaft	1		38	3 4 9 F 0 5 3 2 B	Plate, rack side	2	
6	3 6 2 F 1 1 4 4	Support	1		39	3 1 3 F 0 5 7 5 B	Stay	9	
7	3 3 4 F 3 5 2 9	Roller, rubber	1		40	3 2 2 F C 2 2 6	Support, shaft	1	
8	3 3 4 F 3 4 0 7	Roller, rubber	1		41	3 1 9 F 2 7 8 7	Shaft	3	
9	3 3 4 F 2 7 3 6	Roller, resin	2		42	3 2 2 F C 0 8 4	Support, shaft	51	
10	3 1 9 F 3 6 0 9	Shaft	1		43	3 8 8 F 2 1 4 8 A	Spring, tension	16	
11	3 3 5 F 0 0 8 8	Flange	8		44	3 1 9 F 3 7 7 0	Shaft	2	
12	3 4 9 F 0 5 2 9 B	Plate, rack side	1		45	3 4 9 F 0 5 3 2 B	Plate, rack side	2	
13	3 3 5 F 0 0 8 9	Flange	4		46	3 6 3 F 2 1 9 0	Guide	7	
14	3 4 7 F 0 9 2 4	Spacer	7		47	3 1 3 F 0 5 7 6 B	Stay	18	
15	3 1 3 F 0 5 7 5 B	Stay	9		48	3 4 7 F 0 9 2 5	Spacer	11	
16	3 6 3 F 3 6 6 1	Guide	14		49	3 6 3 F 2 1 9 1	Guide	7	
17	3 1 9 F 2 7 8 6	Shaft	2		50	3 5 0 F 2 9 4 8 D	Cover	1	
18	3 2 2 F C 0 5 2	Support, shaft	6		51	3 2 7 F 1 2 0 1 3 1 1	Gear, spur	2	
19	3 8 8 F 2 1 4 8 A	Spring, tension	16		52	3 2 7 F 1 2 0 1 3 0 6	Gear, spur	8	
20	3 2 2 F C 1 6 2	Support, shaft	15		53	3 2 7 F 1 2 0 1 5 1 3 A	Gear, spur	1	
21	3 3 8 F 0 2 3 4	Collar	2		54	3 2 7 F 1 2 0 1 4 0 1	Gear, spur	2	
22	3 2 7 F 1 1 2 1 6 2 5	Gear, spur	1		55	3 3 4 F 3 3 5 4 B	Roller, rubber	1	
23	3 3 8 S 0 0 1 0	Ring	35		56	3 3 4 F 4 0 1 9 B	Roller, cloth	1	
24	3 3 8 F 0 6 8 0	Collar	3		57	3 3 4 F 3 3 5 5 B	Roller, rubber	1	
25	3 2 7 F 2 2 0 2 4 0 1	Gear, helical	1		58	3 3 4 F 2 6 9 6 B	Roller, resin	7	
26	3 0 9 F 0 0 7 0	Washer	6		59	3 3 4 F 2 8 1 6 A	Roller, resin	1	
27	3 1 0 F 1 0 0 2 0 1 8	Pin, straight	7	Diam. 2 ∅ 18	60	3 3 4 F 4 0 2 3 B	Roller, cloth	3	
28	3 2 7 F 1 1 2 2 0 3 5	Gear, spur	13						
29	3 2 7 F 1 1 2 1 6 0 1	Gear, spur	1		①	8 0 2 H 0 3 5 1	F-W crossover rack ass'y		
30	3 2 7 F 1 1 2 2 0 3 5	Gear, spur	13		②	8 0 2 H 0 1 8 6 A	Squeegee rack ass'y		Excluding 06-50 Cover
31	3 0 8 F 0 3 2 5	Screw, special	4						
32	3 2 2 F C 0 8 4	Support, shaft	51						
33	3 4 9 F 0 5 2 8 B	Plate, rack side	1						

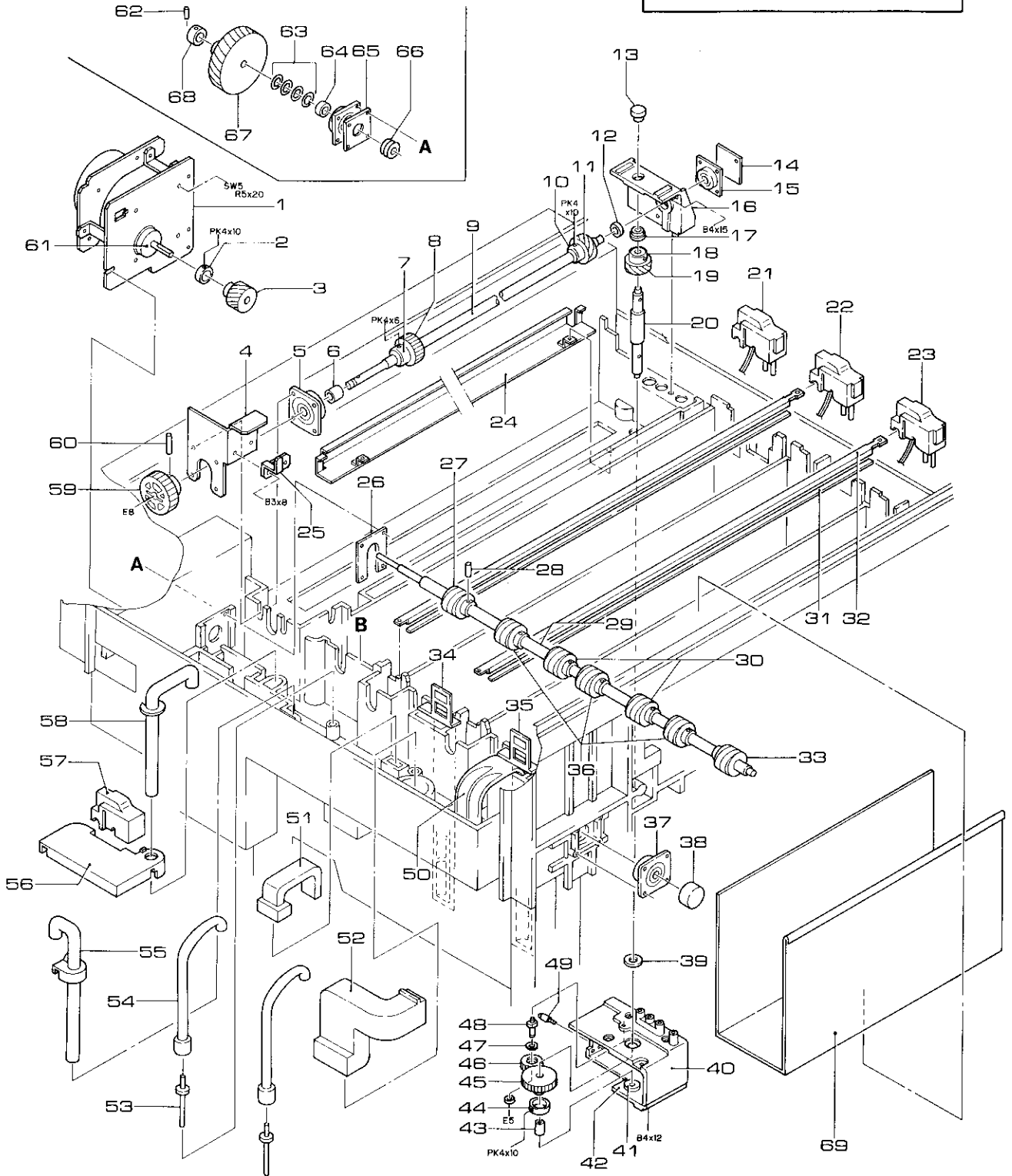
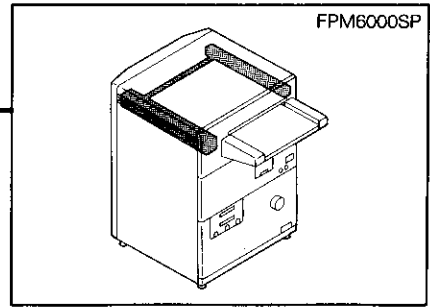

## ● DRIVE/PROCESSING SECTIONS

Drawing					Drawing				
Ref. No.	Part No.	Part Name	Qty	Remarks	Ref. No.	Part No.	Part Name	Qty	Remarks
1	356F10439A	Bracket	1		36	327F4202R10	Worm	3	
2	338F0311	Ring	5		37	321S0012	Shaft support unit	4	ORIJIN FU-10EZZ
3	327F2201301	Gear, helical	1		38	350F2368	Cover	1	
4	305F0210A	Nut	1		39	322FA014	Support, shaft	3	ORIJIN SST10-18
5	321S0012	Shaft support unit	4	ORIJIN FU-10EZZ	40	356F7709	Bracket	1	
6	338F0679	Collar	1		41	322FA006	Support, shaft	3	ORIJIN SSF10-19ZZ
7	338S0010	Ring	35		42	356F7710	Bracket	1	
8	327F1201310	Gear, spur	1		43	338F0682	Collar	1	
9	319F3768	Shaft	1		44	338F0311	Ring	5	
10	338F0311	Ring	5		45	327F1202019A	Gear, spur	1	
11	327F2201002A	Gear, helical	1		46	327F1201314	Gear, spur	1	
12	322FA014	Support, shaft	3	ORIJIN SST10-18	47	322FA026	Support, shaft	2	ORIJIN SS7-14ZZ
13	317F1083	Cap	1		48	319F3788A	Shaft	1	
14	305F0197	Nut	1		49	308F0301A	Screw, special	1	
15	321S0012	Shaft support unit	4	ORIJIN FU-10EZZ	50	371F0591C	Nozzle	1	
16	356F7708	Bracket	1		51	371F0663	Nozzle	1	
17	322FA004	Support, shaft	1	ORIJIN SSF8-16ZZ	52	369F0361	Duct	1	
18	338F0311	Ring	5		53	371F0546B	Nozzle	2	
19	327F2201003	Gear, helical	1		54	371F0545B	Nozzle	2	
20	319F3883	Shaft	1		55	371F0647A	Nozzle	1	
21	380H0063B	Detector	1	DAIYU S3	56	343F0138B	Hook	1	
22	380H0062A	Detector	1	DAIYU S2	57	380H0064A	Detector	1	DAIYU S8
23	380H0061A	Detector	1	DAIYU S1	58	371F0650B	Nozzle	1	
24	363F3052	Guide	1		59	327F2202007C	Gear, helical	1	
25	356F8759B	Bracket	1		60	310F1002018	Pin, straight	7	
26	305F0164	Nut	2		61	118H0122	Motor	1	M1
27	327F4202L08	Worm	1		62	310F1003020	Pin, straight	8	TAIYOH SP 3x20
28	310F1003020	Pin, straight	8	TAIYOH SP 3x20	63	322F2133	Support, shaft	1	ASAHI STW-FT100 t0.25
29	319F3767B	Shaft	1		64	338F0460	Collar	4	
30	327F4203L01	Worm	2		65	356F7706	Bracket	1	
31	382F0424	Tape, sponge	2		66	322FA002	Support, shaft	1	ORIJIN SST12-23
32	363E3832A	Guide	2		67	327F2203701A	Gear, helical	1	
33	327F4202L04A	Worm	1		68	338F0311	Ring	5	
34	376F0180	Filter, mechanical	2		69	345F1907A	Plate, shield	1	
35	376F0180	Filter, mechanical	2						

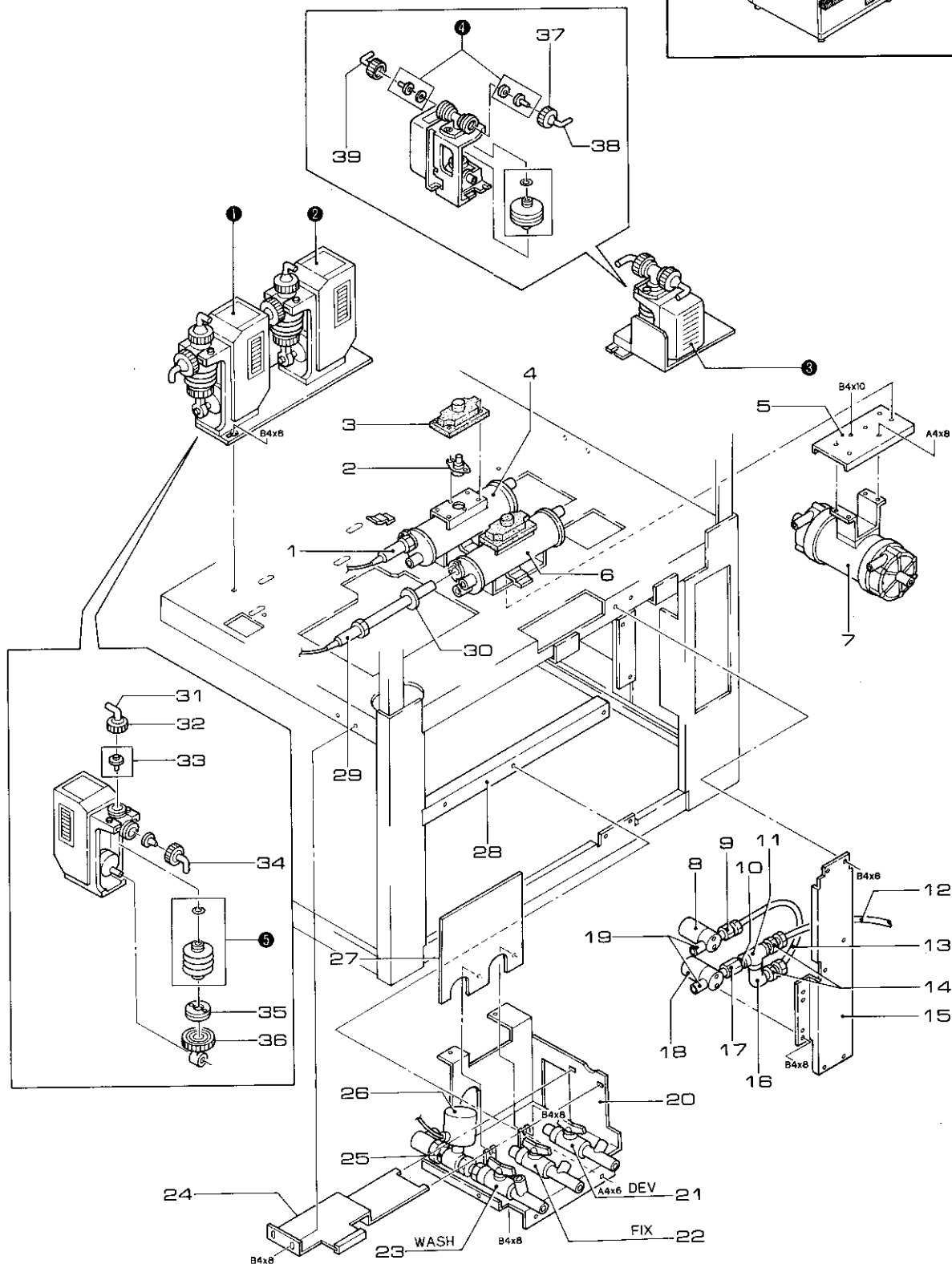
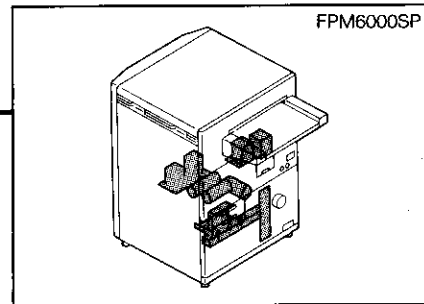

## ● PROCESSING SECTION

## Drawing

Ref. No.	Part No.	Part Name	Qty	Remarks
1	117H0058A	Heater	1	H2(FIX)
2	115F1091	Thermostat, safety	2	TH1, TH2
3	350F8362317	Cover	2	
4	379H0023	Exchanger, heat	1	FIX
5	356F7687B	Bracket	1	
6	379H0022	Exchanger, heat	1	DEV
7	133H0127A	Pump, electric	1	MP1
8	134H0184	Valve, solenoid	1	SV1 WASH
9	374F2168	Valve	1	
10	372F0067	Fitting, tube	1	
11	372F0390A	Fitting, tube	1	
12	370FP001200	Hose	1	
13	370FP001030	Hose	1	
14	372F1245	Fitting, tube	2	
15	356F8393	Bracket	1	
16	372F0549	Elbow	1	
17	374F2010	Valve	1	
18	134H0185	Valve, solenoid	1	SV2 COOLING
19	371F0279	Fitting, tube	2	
20	356F8392B	Bracket	1	
21	374F2210	Valve	1	DEV
22	374F2211	Valve	1	FIX
23	374F2142	Valve	1	WASH
24	356F8777	Bracket	1	
25	372F0783	Fitting, tube	1	
26	134H0183	Valve, electric	1	SV3

SHINWA KMS-28UL

## Drawing

Ref. No.	Part No.	Part Name	Qty	Remarks
27	356F8449B	Bracket	1	
28	346F2019A	Plate, auxiliary	1	
29	117H0057A	Heater	1	H1(DEV)
30	375F0257A	Packing	2	
31	133F1454	Pump	2	Exhaust port
32	133F1451	Pump	4	Cap
33	133F1452	Pump	4	Valve, poppet
34	133F1453	Pump	2	Suction port
35	133F1455	Pump	2	Cap, end
36	133F1323	Pump	2	Variable cam set
37	133F1438	Pump	4	Cap
38	133F1435	Pump	1	Exhaust port
39	133F1437	Pump	1	Suction port
①	133H0224	Pump, electric	1	BP4 FIX replenishment
②	133H0223	Pump, electric	1	BP1 DEV replenishment KBM-3YU4-S21
③	133H0227A	Pump, electric	1	BP4 F. W Crossover roller cleaning KBR-3XAU1M
④	375F0177	Packing	2	
⑤	133F1450	Pump	2	O-ring, bellows

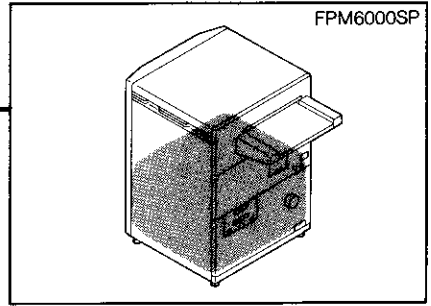

Shape	Symbol	30	33
A	○	31	34
B	●	32	35
C	△	□	36
	■	37	
	x	38	

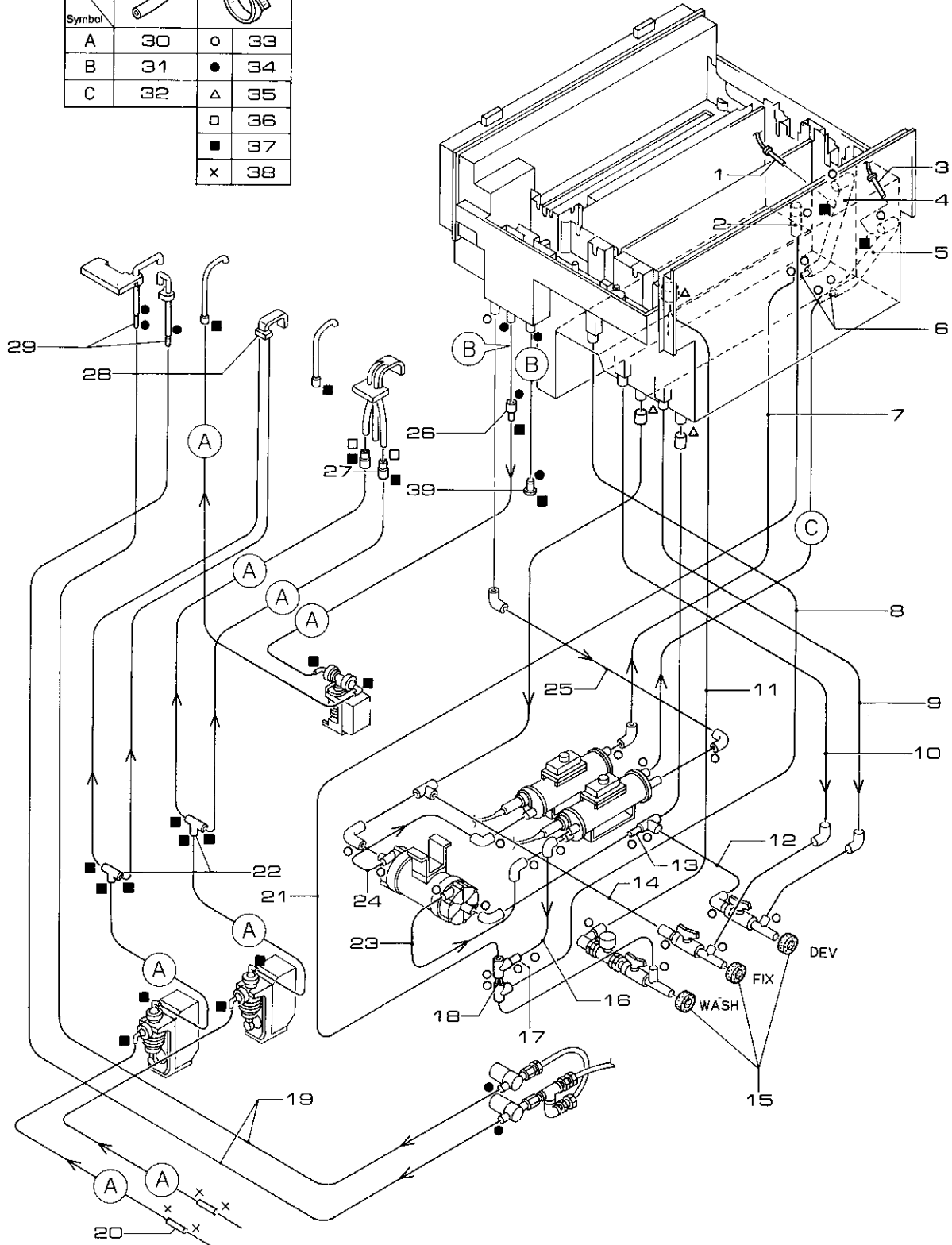

## ● PIPING SECTION

Drawing				Drawing			
Ref. No.	Part No.	Part Name	Qty Remarks	Ref. No.	Part No.	Part Name	Qty Remarks
1	115H0072	Thermistor	1 RT2 TECHNO SEVEN	21	372F1237	Fitting, tube	1
2	372F1238	Fitting, tube	1	22	372F0947	Fitting, tube	2
3	115H0071	Thermistor	1 RT1 TECHNO SEVEN	23	372F1257	Fitting, tube	1
4	372F1244A	Fitting, tube	1	24	372F1464	Fitting, tube	1
5	372F1243A	Fitting, tube	1	25	372F1240A	Fitting, tube	1
6	372F0748A	Fitting, tube	4	26	372F0724	Fitting, tube	1
7	372F1462	Fitting, tube	1	27	372F0531	Fitting, tube	2
8	372F1420	Fitting, tube	1	28	371F0663	Nozzle	1
9	372F1233	Fitting, tube	1	29	372S0011A	Fitting, tube	2
10	372F1463	Fitting, tube	1	30	370FY017	Hose	1
11	372F1239	Fitting, tube	1	31	370S112E010	Hose	2
12	372F1231B	Fitting, tube	1	32	370S116C020	Hose	1
13	372F0748A	Fitting, tube	4	33	316S2012	Clamp, hose	33 ND-10
14	372F1461	Fitting, tube	1	34	316S2035	Clamp, hose	10 MC-6
15	345F1263A	Shield, light	3	35	316S2013	Clamp, hose	3 ND-12
16	372F1259	Fitting, tube	1	36	316F2053	Clamp, hose	2 SNP-1.5
17	372F0748A	Fitting, tube	4	37	316F2055	Clamp, hose	23 SNP-4-HSD
18	372F0748A	Fitting, tube	4	38	316F2054	Clamp, hose	4
19	372F1260	Fitting, tube	1	39	317F1107	Plug	1
20	371F0277	Nozzle	2				

## DRYER RACK (1)

FPM6000SP

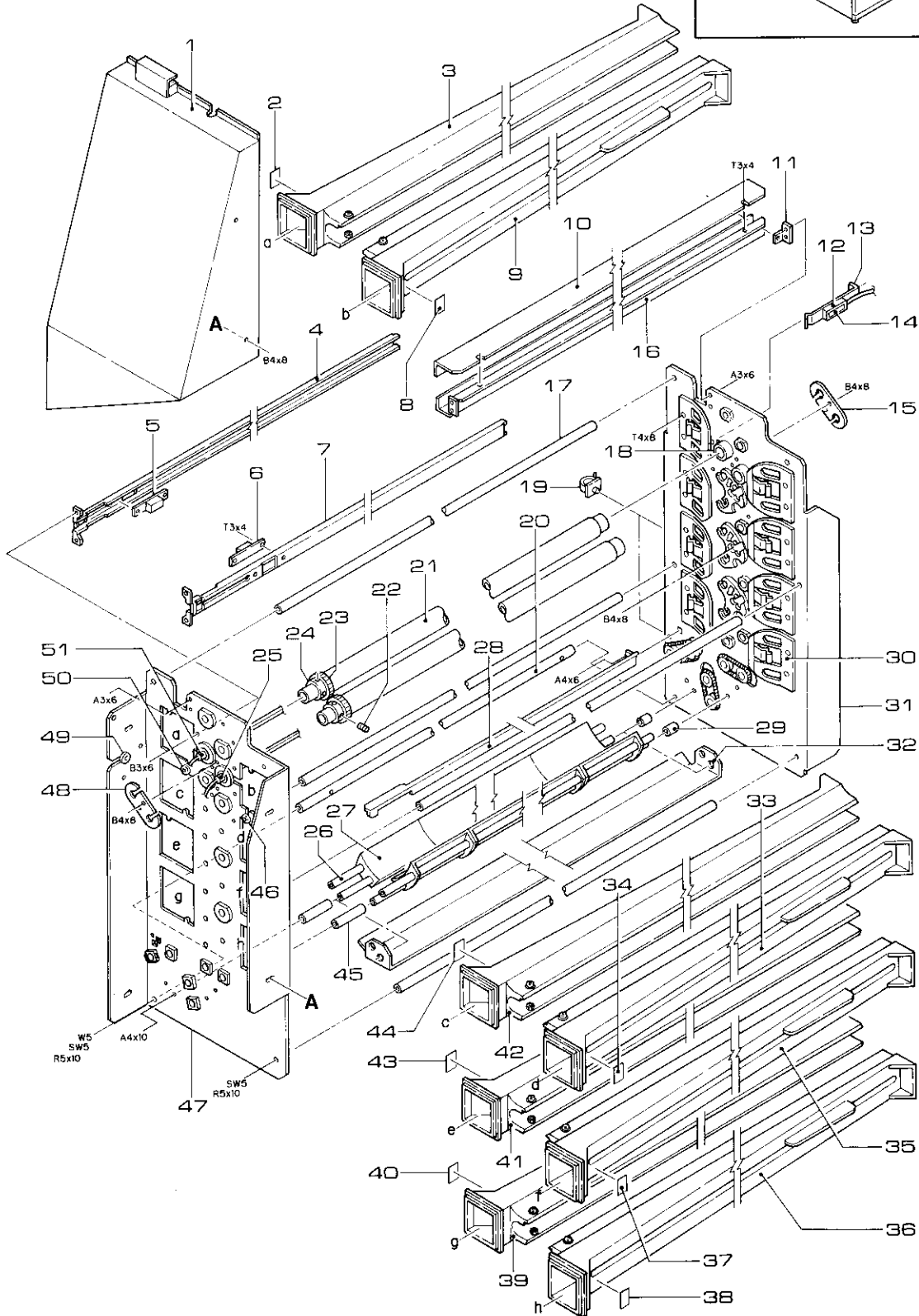
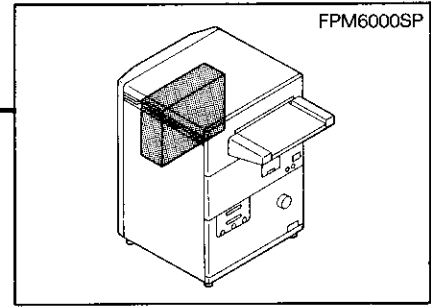



● DRYER RACK (1)

Drawing			
Ref. No.	Part No.	Part Name	Qty Remarks
1	361F1136	Chamber	1
2	405F7365	Label	1 Spray pipe 1
3	371F0595A	Pipe, spray	4 No. 1
4	356F7692	Bracket	1
5	115H0069A	Thermistor	1 RT4
6	115H0070A	Thermistor	1 RT5
7	356F7693	Bracket	1
8	405F7369	Label	1 Spray pipe 5
9	371F0596A	Pipe, spray	4 No. 5
10	350F4069A	Cover	1
11	356F7019A	Bracket	1
12	347F1369	Spacer	2
13	356F7002	Bracket	2
14	115H0074A	Safety thermostat ass'y	1 Protector, thermal
15	356F6692	Bracket	2
16	369F0323A	Duct	1
17	319F2845A	Shaft	5
18	322FC285A	Support, shaft	4
19	316F7055	Clamp, cord	6 CKS-13-L
20	319F3786A	Shaft	1
21	334F1228A	Roller, metallic	2
22	308F3033	Screw, special	2
23	327F1122056	Gear, spur	4
24	338F0623	Collar	2
25	117H0034B	Heater	1 HR2

Drawing			
Ref. No.	Part No.	Part Name	Qty Remarks
26	319F2846B	Shaft	4
27	363F2189	Guide	28
28	363F2675-BF	Plate, guide	1
29	347F0964A	Spacer	2
30	356F4938C	Bracket	8
31	348F1066B	Plate, side	1
32	345F1559	Plate, shield	1
33	371F0596A	Pipe, spray	4 No. 6
34	405F7370	Label	1 Spray pipe 6
35	371F0596A	Pipe, spray	4 No. 7
36	371F0596A	Pipe, spray	4 No. 8
37	405F7371	Label	1 Spray pipe 7
38	405F7372	Label	1 Spray pipe 8
39	371F0595A	Pipe, spray	4 No. 4
40	405F7368	Label	1 Spray pipe 4
41	371F0595A	Pipe, spray	4 No. 3
42	371F0595A	Pipe, spray	4 No. 2
43	405F7367	Label	1 Spray pipe 3
44	405F7366	Label	1 Spray pipe 2
45	347F0965A	Spacer	2
46	318F3924	Grommet	2 C-30-NG-742
47	348F1067A	Plate, side	1
48	356F6690A	Bracket	1
49	318F3105	Grommet	1 C-30-NG-79-D
50	318F3924	Grommet	2 C-30-NG-742
51	117H0033B	Heater	1 HR1

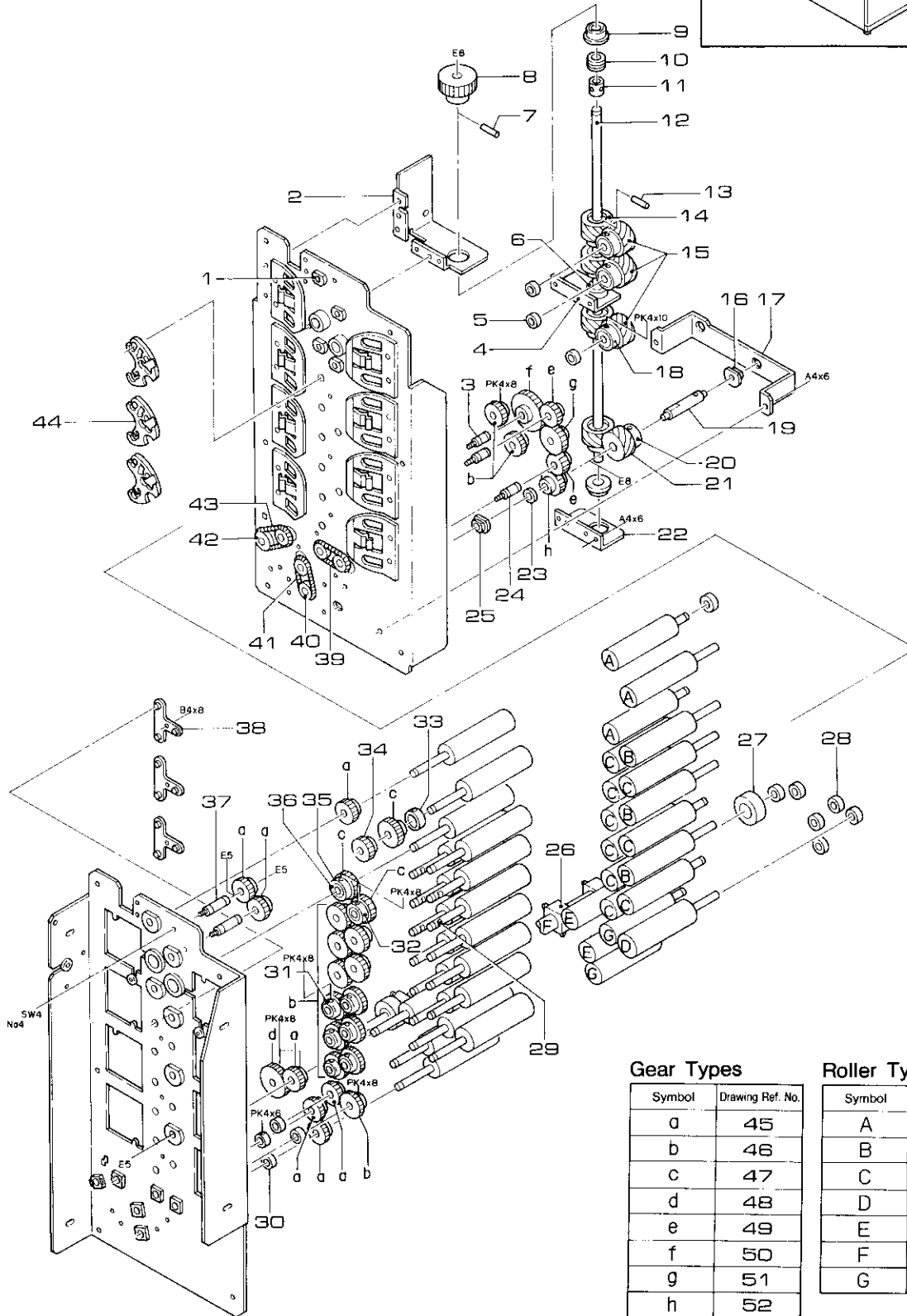
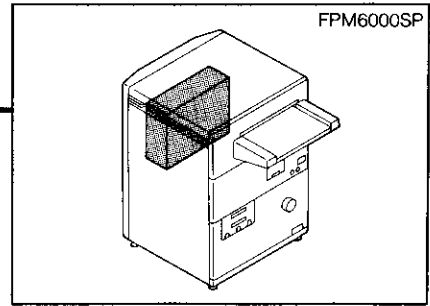

### Gear Types

Symbol	Drawing Ref. No.
a	45
b	46
c	47
d	48
e	49
f	50
g	51
h	52

### Roller Types

Symbol	Drawing Ref. No.
A	53
B	54
C	55
D	56
E	57
F	58
G	59

● DRYER RACK (2)

Drawing			
Ref. No.	Part No.	Part Name	Qty Remarks
1	322FC205	Support, shaft	80
2	356F7747A	Bracket	1
3	319F3787A	Shaft	1
4	356F4937C	Bracket	1
5	347F0999	Spacer	3
6	322FC162	Support, shaft	22
7	310F0455	Pin, straight	1
8	327F1201605	Gear, spur	1
9	322FA006	Support, shaft	3
10	322FA014	Support, shaft	3
11	338F0678	Ring	1
12	319F3766A	Shaft	1
13	310F1002016	Pin, straight	4 Diam. 2 ∅18
14	327F2151315A	Gear, helical	4
15	327F2151313C	Gear, helical	3
16	322FC205	Support, shaft	80
17	356F7746	Bracket	1
18	338S0011	Ring	4
19	319F2847A	Shaft	1
20	338S0011	Ring	5
21	327F2151312C	Gear, helical	1
22	356F4998E	Bracket	1
23	322F2054	Support, shaft	1
24	319F3654	Shaft	4
25	322FC205	Support, shaft	80
26	326F0037B	Roller, special	9
27	334F9152	Roller, rubber	2
28	347F1041	Spacer	6
29	405F1110	Seal, mark	5
30	338F8342841	Ring	4

Drawing			
Ref. No.	Part No.	Part Name	Qty Remarks
31	338S0010	Ring	34
32	338F0623	Collar	5
33	338F0623	Collar	5
34	327F1121637	Gear, spur	1
35	319F3560A	Shaft	2
36	338F0623	Collar	4
37	319F3654	Shaft	4
38	322FC292	Support, shaft	3
39	388F2148A	Spring, tension	16 ∅80
40	322FC294	Support, shaft	12
41	388F2146A	Spring, tension	10 ∅65
42	322FC294	Support, shaft	12
43	388F2147A	Spring, tension	14 ∅85
44	322FC293	Support, shaft	3
45	327F1121626A	Gear, spur	7
46	327F1122047A	Gear, spur	14
47	327F1122056	Gear, spur	5
48	327F1122401	Gear, spur	1
49	327F1122006	Gear, spur	2
50	327F1123605	Gear, spur	1
51	327F1122501	Gear, spur	1
52	327F1122054	Gear, spur	1
53	334F2848B	Roller, resin	3
54	334F2847A	Roller, resin	3
55	334F2844A	Roller, resin	9
56	334F2846A	Roller, resin	1
57	334F2849A	Roller, resin	2
58	334F0076B	Roller	1
59	334F2845B	Roller, resin	2

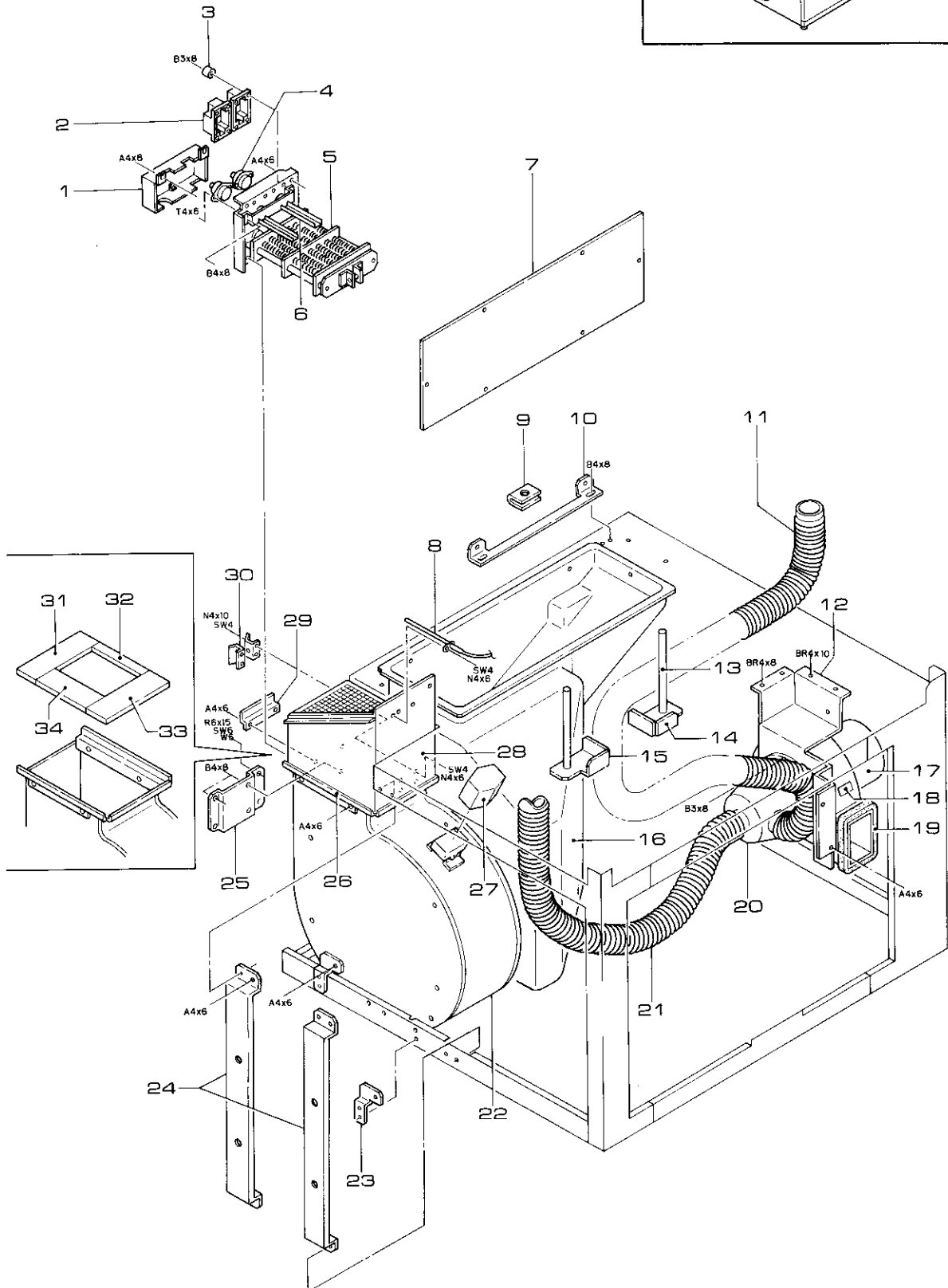
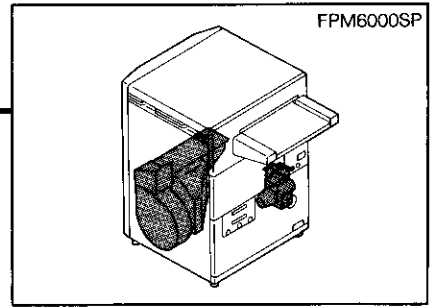

● DRYER FAN SECTION

Drawing				Drawing			
Ref. No.	Part No.	Part Name	Qty Remarks	Ref. No.	Part No.	Part Name	Qty Remarks
1	350F4710	Cover	1	18	405F7373A	Label	1
2	350F4062	Cover	2	19	382F0100-M002	Tape, sponge	1 t8xW12x L 300
3	347F1687	Spacer	8	20	372F1230A	Fitting, tube	1
4	115F1090	Thermostat, safety	1 NIHON GT #05-9230-090A78 78°C OFF	21	370FA002090	Hose, flexible	1 TOHTAKU
5	117H0078	Heater	1 H3/H4	22	119F2066	Fan, electric	1 FAN1 Dryer fan ass'y
6	356F8384	Bracket	1	23	356F4889A	Bracket	2
7	350F4343A	Cover	1	24	346F2028	Plate, brace	2
8	115H0073	Thermistor	1 RT3 TECHNO SEVEN	25	356F8394A	Bracket	1
9	305F0191	Nut	4	26	346F1817	Plate, auxiliary	1
10	356F7742	Bracket	1	27	350F2338	Cover	3
11	370FA001115	Hose, flexible	1	28	358F0538	Box	1
12	356F8391	Bracket	1	29	346F2018	Plate, auxiliary	1
13	308F0300	Screw, special	2	30	356F7794A	Bracket	2
14	356F7736A	Bracket	1	31	382F0514	Tape, sponge	1
15	356F7737A	Bracket	1	32	382F0516	Tape, sponge	2
16	369F0364C	Duct	1	33	382F0524	Tape, sponge	1
17	119H0090	Fan, electric	1 FAN2	34	382F0516	Tape, sponge	2

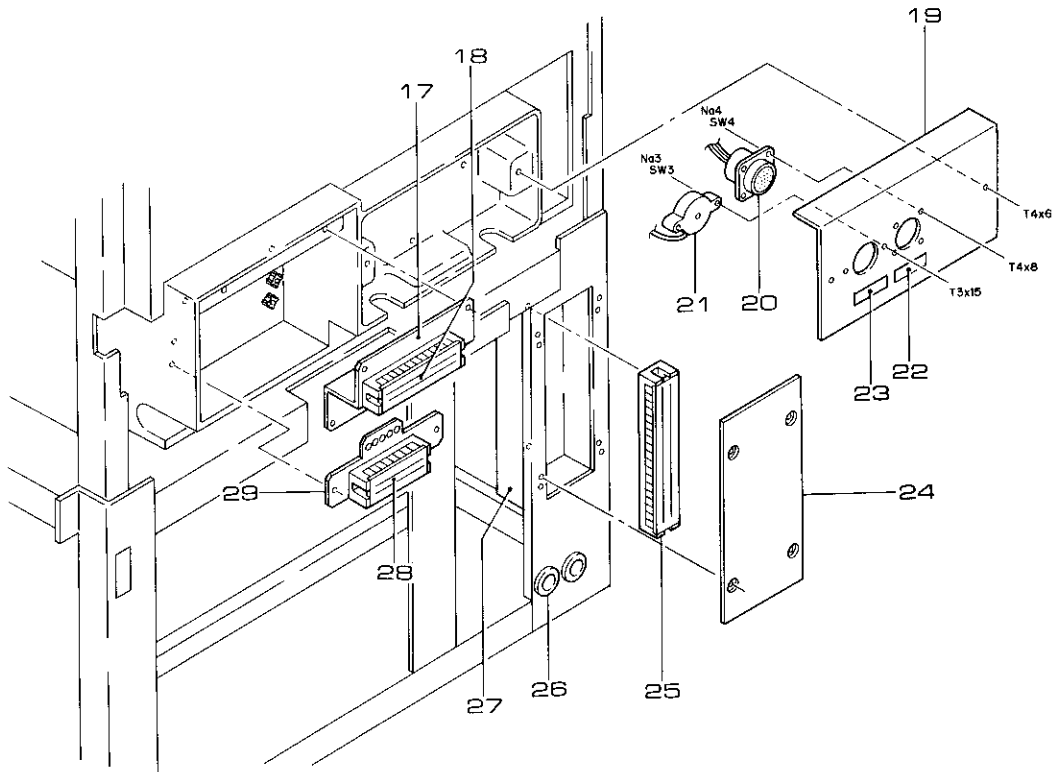
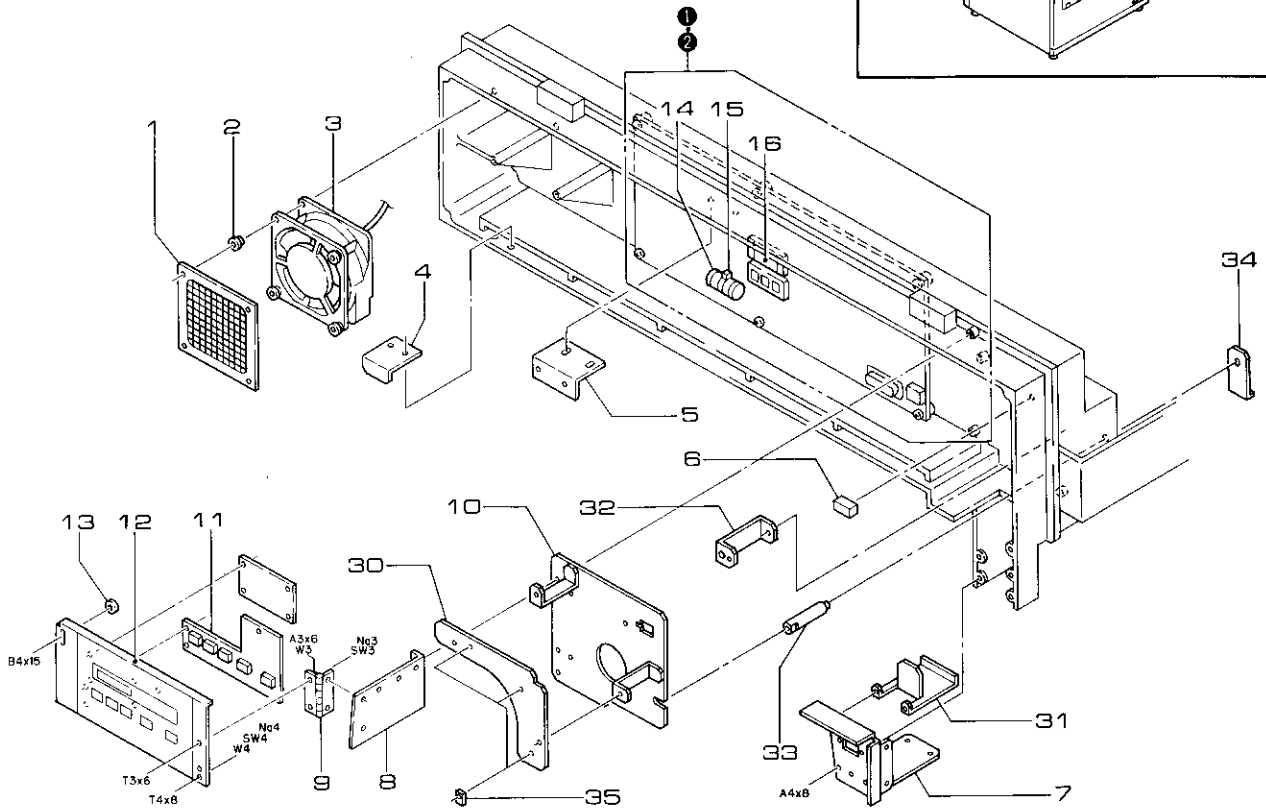
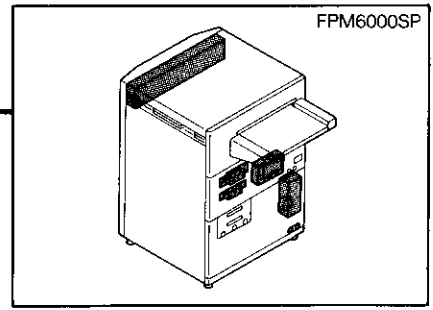

## ● CONTROL SECTION (1)

Drawing				Drawing			
Ref. No.	Part No.	Part Name	Qty Remarks	Ref. No.	Part No.	Part Name	Qty Remarks
1	376F0116	Filter	1	21	121F9009	Buzzer	1 Ass'y
2	322F2042	Support, shaft	4 80F-0303	22	405F7430	Label	1 IF(CN126)
3	119F1147	Fan, electric	1 FAN4	23	405F7429	Label	1 BUZZER
4	305F0186	Nut	1	24	350F4709	Cover	1
5	356F8814	Bracket	1	25	135F9373	Strip, terminal	1
6	128F9707	Switch	2	26	318F3117	Grommet	2
7	356F10441	Bracket	1	27	356F8383A	Bracket	1
8	356F4894	Bracket	1	28	135F9371	Strip, terminal	1
9	314F0086	Hinge	1	29	356F8390	Bracket	1
10	356F10439A	Bracket	1 For SP/RP	30	356F10437	Bracket	4
11	113H0221A	PCB ass'y section	1	31	356F10440	Bracket	1
12	126H0038	Indicator	1 Ass'y	32	356F10436	Bracket	1
13	309F0050	Washer, plastic	7	33	319F4598	Shaft	1
14	125F0056	Battery	1	34	356F10438	Bracket	1
15	316S1001	Tie, wire	100 TAITON T18R	35	316F1107	Cable, clamp	3
16	114FP108020D	ROM	1	①	857H0024E	PCB ass'y	1 PCB, NMC
17	356F8389	Bracket	1	②	113H0219C	PCB ass'y	1 PCB, NMC (Without ROM)
18	135F9372	Strip, terminal	1				
19	356F4882A	Bracket	1				
20	136H2366	Cable	1 I/F				

## CONTROL SECTION (2)

FPM6000SP

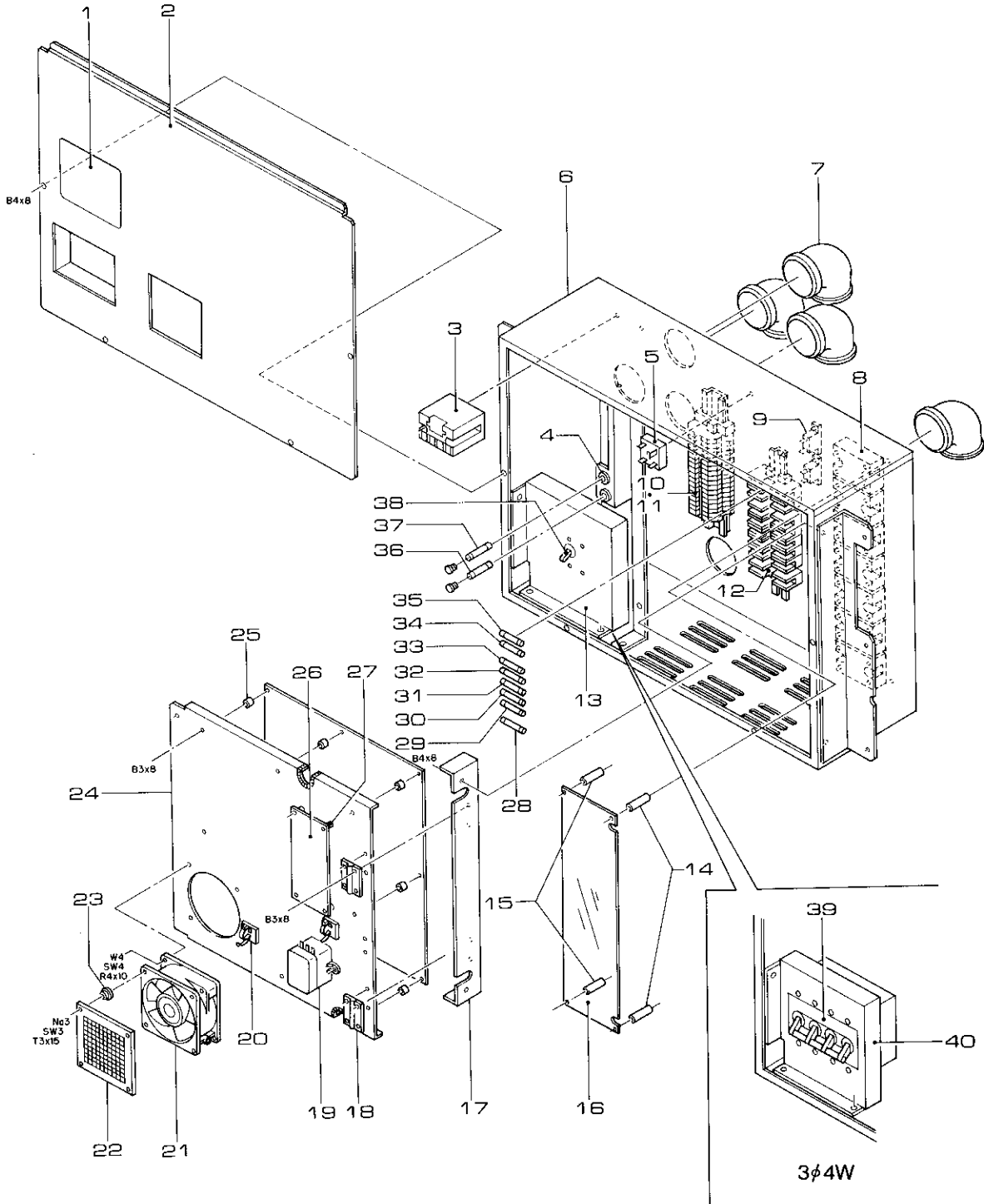
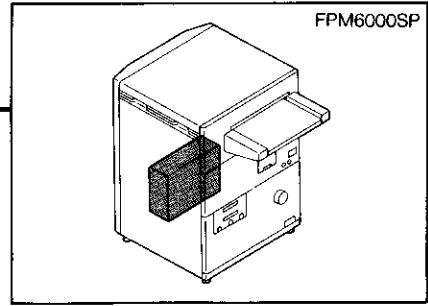



● CONTROL SECTION (2)

Drawing

Ref. No.	Part No.	Part Name	Qty	Remarks
1	405F0347	Label	1	
2	350F4718A	Cover	1	
3	131F2160	Relay	1	
4	137F2077	Holder, fuse	2	
5	100SS25VB10	Diode bridge	1	
6	358F0541A	Box	1	
7	318S3049	Grommet	6	
8	131F9006	SSR	7	
9	109F1006	Coil	2	
10	135H0018	Strip, terminal	1	For 3-phase 4-wire
11	135H0020	Strip, terminal	1	For single phase
12	137H0003	Holder, fuse	1	
13	356F8397	Bracket	1	For single phase (UL included)
14	347F1597	Spacer	2	
15	347F1601	Spacer	2	MO-30
16	350F4722	Cover	1	
17	356F8398	Bracket	1	
18	314F003	Hinge	2	
19	138F0021	Suppressor, noise	1	
20	316S0046	Clamp, cord	17	
21	119H0091	Fan, electric	1	FAN3
22	376F0116	Filter	1	

Drawing

Ref. No.	Part No.	Part Name	Qty	Remarks
23	322F2042	Support, shaft	4	
24	353F0273	Chassis	1	
25	347S0035	Spacer	8	
26	125F0145	Power supply	1	
27	347S0080	Spacer	4	
28	137F1059	Fuse	1	
29	137F1059	Fuse	1	
30	137F1059	Fuse	1	
31	137F1059	Fuse	1	
32	137F1119	Fuse	1	
33	137F1119	Fuse	1	
34	137F1039	Fuse	1	
35	137F1039	Fuse	1	
36	137F1139	Fuse	1	
37	137F1140	Fuse	1	
38	128FA099	Breaker	1	For single phase (TUV included) (UL included)
39	128FA067	Breaker	1	For 3-phase 4-wire (TUV included)
40	350F8395	Bracket	1	For 3-phase 4-wire (TUV included)

## CONTROL SECTION (3)

FPM6000SP

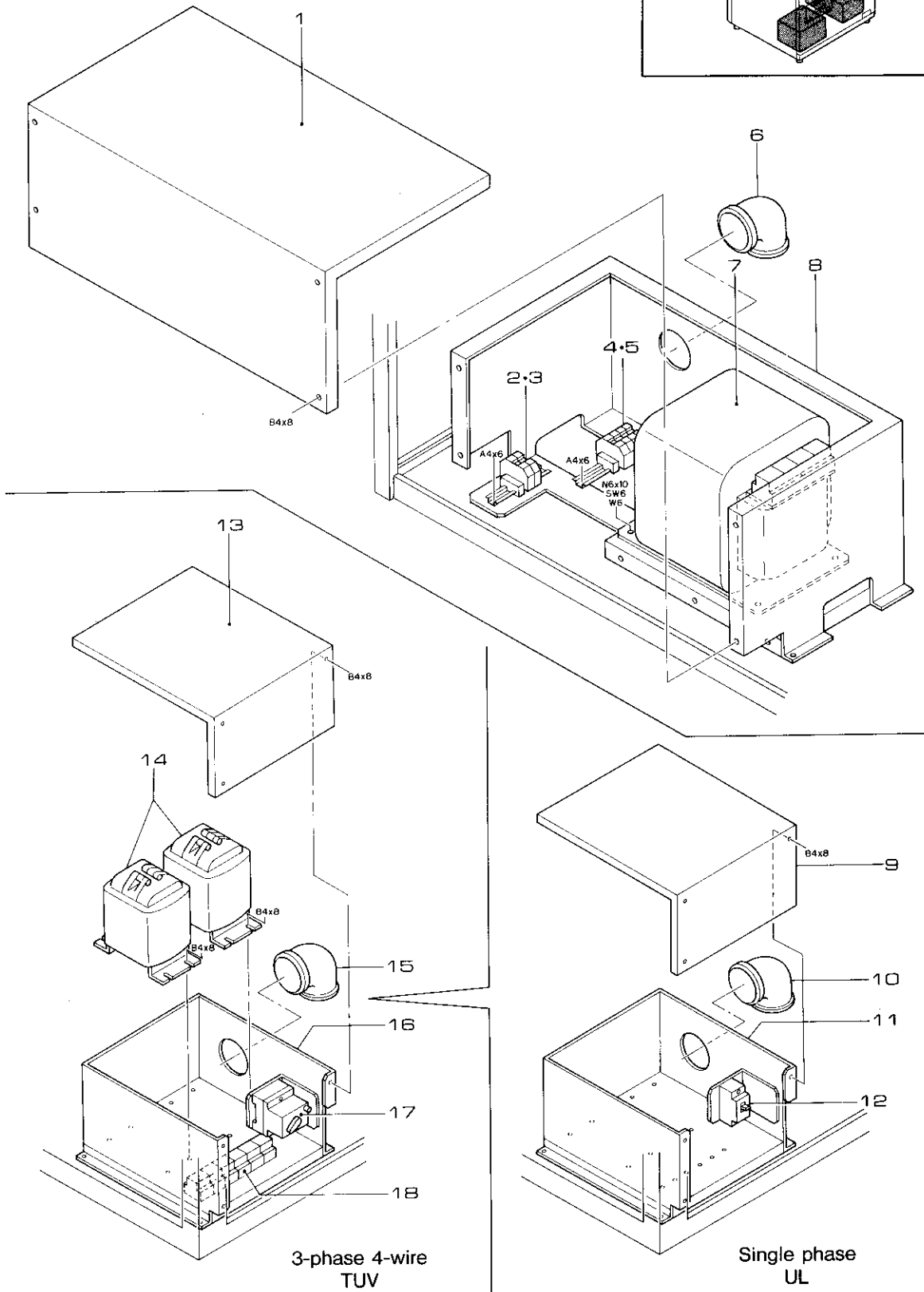
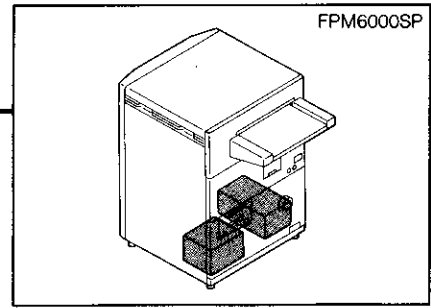

● CONTROL SECTION (3)

Drawing				Drawing			
Ref. No.	Part No.	Part Name	Qty Remarks	Ref. No.	Part No.	Part Name	Qty Remarks
1	350F4713	Cover	1	10	318S3049	Grommet	6
2	135H0012	Strip, terminal	1 PHENIX CONTACT MBK/6E TUV(3-phase 4-wire)	11	358F0539B	Box	1
3	135H0016	Strip, terminal	1 PHENIX CONTACT MBK/6E UL(Single phase)	12	128F3084	Breaker	1 MATSUSHITA BJS30-3-100F UL(Single phase)
4	135H0013	Strip, terminal	1 PHENIX CONTACT MBK/6E TUV(3-phase 4-wire)	13	350F4712	Cover	1
5	135H0017	Strip, terminal	1 PHENIX CONTACT MBK/6E UL(Single phase)	14	108F0228A	Transformer	2 TOHA TUV(3-phase 4-wire)
6	318S3049	Grommet	6	15	358F0539B	Box	1
7	108F0240	Transformer	1 TOHA	16	318S3049	Grommet	6
8	358F0540B	Box	1	17	128F9952	Breaker	1 CLOCKNAMLAR FIP40-4/0.03 TUV(3-phase 4-wire)
9	350F4712	Cover	1	18	135F9295	Breaker	3 PHENIX CONTACT G10/4 TUV(3-phase 4-wire)

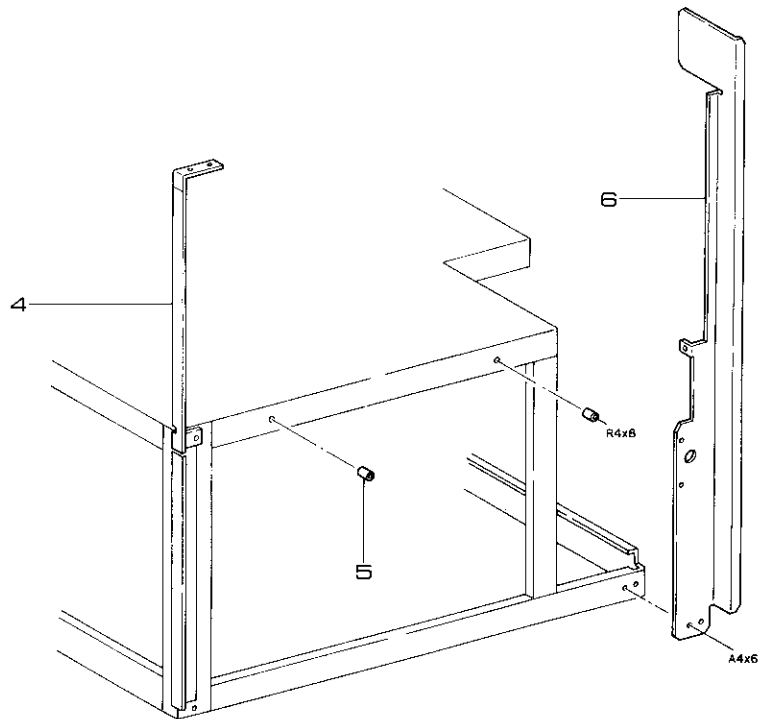
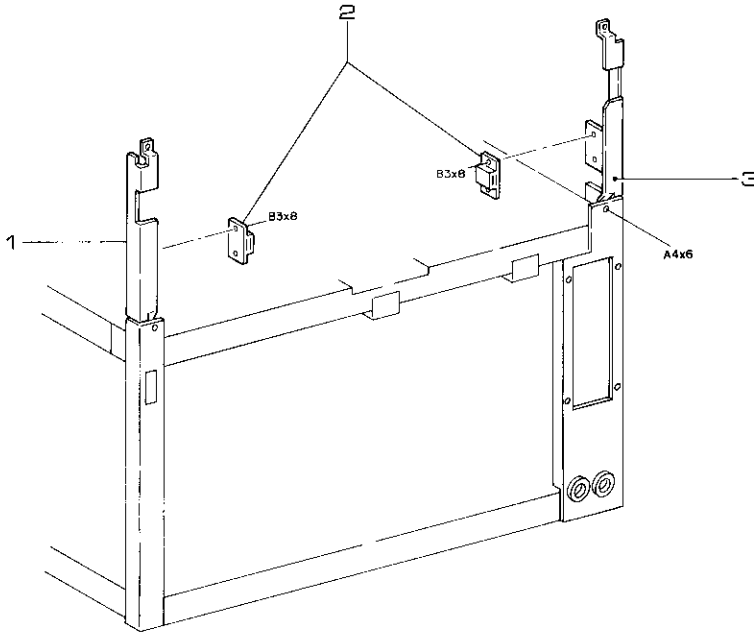
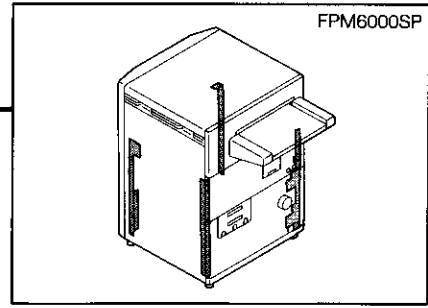

● BODY FRAME (2)

Drawing					Drawing				
Ref. No.	Part No.	Part Name	Qty	Remarks	Ref. No.	Part No.	Part Name	Qty	Remarks
1	3 4 6 F 1 8 1 2 B	Plate, auxiliary	1		4	3 4 6 F 1 8 1 5 B	Plate, auxiliary	1	
2	3 1 6 S 3 0 3 0	Catch	5	TAKIGEN C-54-1	5	3 4 7 F 1 0 4 3	Spacer	2	
3	3 4 6 F 1 8 1 3 B	Plate, auxiliary	1		6	3 4 6 F 2 0 4 9 A	Plate, auxiliary	1	

Part No.	Index No.-Ref. No.	Part No.	Index No.-Ref. No.	Part No.	Index No.-Ref. No.
100SS25VB10	14-05	135F9295	15-18	310F1002018	05-18
108F0228A	15-14	135F9371	13-28	310F1002018	05-37
108F0240	15-07	135F9372	13-18	310F1002018	06-27
109F1006	14-09	135F9373	13-25	310F1002018	07-60
113F0647A	01-20	135H0012	15-02	310F1003020	07-28
113H0219C	13-②	135H0013	15-04	310F1003020	07-62
113H0221A	13-11	135H0016	15-03	313F0575B	05-11
114FP108020D	13-16	135H0017	15-05	313F0575B	05-41
115F1090	12-04	135H0018	14-10	313F0575B	06-15
115F1091	08-02	135H0020	14-11	313F0575B	06-39
115H0069A	10-05	136H1528	01-14	313F0576B	05-09
115H0070A	10-06	136H1528	01-53	313F0576B	05-17
115H0071	09-03	136H2366	13-20	313F0576B	05-40
115H0072	09-01	137F1039	14-34	313F0576B	05-54
115H0073	12-08	137F1039	14-35	313F0576B	06-02
115H0074A	10-14	137F1059	14-28	313F0576B	06-47
117H0033B	10-51	137F1059	14-29	313F0797	05-52
117H0034B	10-25	137F1059	14-30	314F003	14-18
117H0057A	08-29	137F1059	14-31	314F0086	13-09
117H0058A	08-01	137F1119	14-32	316F1107	13-35
117H0078	12-05	137F1119	14-33	316F2053	09-36
118H0122	07-61	137F1139	14-36	316F2054	09-38
119F1147	13-03	137F1140	14-37	316F2055	09-37
119F2066	12-22	137F2077	14-04	316F7055	10-19
119H0090	12-17	137H0003	14-12	316S0046	14-20
119H0091	14-21	138F0021	14-19	316S1001	13-15
121F9009	13-21	305F0050	01-78	316S2012	09-33
125F0056	13-14	305F0164	07-26	316S2013	09-35
125F0145	14-26	305F0165	02-12	316S2035	09-34
126H0038	13-12	305F0165	03-10	316S3030	01-50
128F3084	15-12	305F0165	04-10	316S3030	16-02
128F9707	01-16	305F0186	13-04	317F0078	01-28
128F9707	13-06	305F0191	12-09	317F1083	07-13
128F9952	15-17	305F0197	07-14	317F1107	09-39
128FA067	14-39	305F0210A	07-04	317F1120	01-61
128FA099	14-38	308F0300	12-13	318F3105	10-49
131F2160	14-03	308F0301A	07-49	318F3117	13-26
131F9006	14-08	308F0325	05-34	318F3924	10-46
133F1323	08-36	308F0325	06-31	318F3924	10-50
133F1435	08-38	308F3033	10-22	318S3049	14-07
133F1437	08-39	309F0050	02-14	318S3049	15-06
133F1438	08-37	309F0050	03-13	318S3049	15-10
133F1450	08-⑤	309F0050	04-13	318S3049	15-16
133F1451	08-32	309F0050	13-13	319F2785	05-19
133F1452	08-33	309F0070	02-34	319F2786	05-56
133F1453	08-34	309F0070	03-33	319F2786	06-17
133F1454	08-31	309F0070	04-38	319F2787	06-41
133F1455	08-35	309F0070	05-01	319F2845A	10-17
133H0127A	08-07	309F0070	05-25	319F2846B	10-26
133H0223	08-②	309F0070	06-26	319F2847A	11-19
133H0224	08-①	310F0455	11-07	319F3560A	11-35
133H0227A	08-⑥	310F1002016	11-13	319F3609	06-10
134H0183	08-26	310F1002018	02-17	319F3610A	06-05
134H0184	08-08	310F1002018	03-17	319F3654	11-24
134H0185	08-18	310F1002018	04-29	319F3654	11-37

## FPM6000SP PART NO. INDEX LIST

Part No.	Index No.-Ref. No.	Part No.	Index No.-Ref. No.	Part No.	Index No.-Ref. No.
319F3766A	11-12	322FC205A	03-16	327F1122056	11-47
319F3767B	07-29	322FC205A	04-31	327F1122401	11-48
319F3768	07-09	322FC226	06-40	327F1122501	11-51
319F3769	02-40	322FC285A	10-18	327F1123605	11-50
319F3769	03-39	322FC286	02-29	327F1124008	02-52
319F3769	04-32	322FC286	03-27	327F1124008	03-51
319F3770	06-36	322FC286	04-30	327F1124008	04-49
319F3770	06-44	322FC292	11-38	327F1151904	02-50
319F3786A	10-20	322FC293	11-44	327F1151904	03-49
319F3787A	11-03	322FC294	11-40	327F1151904	04-47
319F3788A	07-48	322FC294	11-42	327F1152008	02-51
319F3883	07-20	325FQ305046	04-04	327F1152008	03-50
319F4598	13-33	325FQ305061	03-04	327F1152008	04-48
321S0012	07-05	325FQ305068	02-04	327F1201306	06-52
321S0012	07-15	326F0037B	11-26	327F1201310	07-08
321S0012	07-37	326F3030902	02-20	327F1201311	06-51
322F2042	13-02	326F3030902	02-33	327F1201314	07-46
322F2042	14-23	326F3030902	03-20	327F1201401	06-54
322F2054	11-23	326F3030902	03-36	327F1201513A	06-53
322F2087	01-60	326F3030902	04-19	327F1201605	11-08
322F2133	07-63	326F3030902	04-33	327F1202019A	07-45
322FA002	07-66	326F3031801	02-31	327F2151312C	11-21
322FA004	07-17	326F3031801	03-31	327F2151313C	11-15
322FA006	07-41	326F3031801	04-35	327F2151315A	11-14
322FA006	11-09	326F8344181A	02-03	327F2201002A	07-11
322FA014	07-12	326F8344181A	03-03	327F2201003	07-19
322FA014	07-39	326F8344181A	04-03	327F2201301	07-03
322FA014	11-10	327F1101002	05-28	327F2202004A	05-02
322FA026	07-47	327F1102008	05-29	327F2202005A	02-35
322FC051	05-31	327F1102015	05-62	327F2202005A	03-34
322FC052	02-06	327F1102020	05-61	327F2202005A	04-37
322FC052	05-59	327F1102507	05-30	327F2202007C	07-59
322FC052	06-18	327F1121601	06-29	327F2202401	05-26
322FC084	02-07	327F1121617	05-04	327F2202401	06-25
322FC084	02-28	327F1121625	06-22	327F2203701A	07-67
322FC084	03-07	327F1121626A	11-45	327F4202L04A	07-33
322FC084	03-28	327F1121637	11-34	327F4202L08	07-27
322FC084	03-40	327F1122006	11-49	327F4202R10	07-36
322FC084	04-07	327F1122031A	02-23	327F4203L01	07-30
322FC084	04-28	327F1122031A	03-25	334F0076B	11-58
322FC084	05-06	327F1122031A	04-25	334F1155B	05-48
322FC084	05-33	327F1122035	02-53	334F1228A	10-21
322FC084	06-32	327F1122035	03-52	334F2694B	05-16
322FC084	06-42	327F1122035	04-50	334F2696B	06-58
322FC162	02-08	327F1122035	05-03	334F2698B	03-48
322FC162	03-08	327F1122035	05-05	334F2698B	04-46
322FC162	04-08	327F1122035	06-28	334F2699B	03-46
322FC162	05-21	327F1122035	06-30	334F2699B	04-44
322FC162	05-58	327F1122039	02-22	334F2710B	03-42
322FC162	06-20	327F1122039	03-22	334F2710B	04-40
322FC162	11-06	327F1122039	04-21	334F2711B	03-45
322FC205	11-01	327F1122039	05-22	334F2711B	04-43
322FC205	11-16	327F1122047A	11-46	334F2712B	03-44
322FC205	11-25	327F1122054	11-52	334F2712B	04-42
322FC205A	02-16	327F1122056	10-23	334F2713B	03-43

Part No.	Index No.-Ref. No.	Part No.	Index No.-Ref. No.	Part No.	Index No.-Ref. No.
334F2713B	04-41	338F0311	07-44	347F0925	05-08
334F2736	05-14	338F0311	07-68	347F0925	05-35
334F2736	05-47	338F0460	07-64	347F0925	05-55
334F2736	06-09	338F0623	10-24	347F0925	06-48
334F2782	03-47	338F0623	11-32	347F0927	02-05
334F2782	04-45	338F0623	11-33	347F0927	03-05
334F2816A	06-59	338F0623	11-36	347F0927	04-05
334F2844A	11-55	338F0678	11-11	347F0964A	10-29
334F2845B	11-59	338F0679	07-06	347F0965A	10-45
334F2846A	11-56	338F0680	05-24	347F0999	11-05
334F2847A	11-54	338F0680	05-27	347F1041	11-28
334F2848B	11-53	338F0680	06-24	347F1043	16-05
334F2849A	11-57	338F0681	02-36	347F1369	10-12
334F2957	02-42	338F0681	03-35	347F1462	01-11
334F2958	02-47	338F0681	04-36	347F1590	05-39
334F2959	02-49	338F0682	07-43	347F1597	14-14
334F2960	02-44	338F8342841	11-30	347F1601	14-15
334F2961	02-43	338S0010	02-02	347F1687	12-03
334F2962	02-45	338S0010	02-21	347S0035	14-25
334F3354B	06-55	338S0010	03-02	347S0080	14-27
334F3355B	06-57	338S0010	03-21	348F1066B	10-31
334F3407	06-08	338S0010	04-02	348F1067A	10-47
334F3418	02-48	338S0010	04-20	349F0527B	05-07
334F3525A	05-15	338S0010	05-23	349F0527B	05-13
334F3527B	03-41	338S0010	05-63	349F0528B	06-33
334F3528A	04-39	338S0010	06-23	349F0529B	06-12
334F3529	06-07	338S0010	07-07	349F0530B	05-36
334F3562	02-46	338S0010	11-31	349F0531B	05-43
334F3563	05-50	338S0011	11-18	349F0532B	06-38
334F3651	05-49	338S0011	11-20	349F0532B	06-45
334F3652	02-41	343F0138B	07-56	349F0611	02-11
334F4019B	06-56	345F1263A	09-15	349F0612	02-19
334F4023B	06-60	345F1559	10-32	349F0613	03-12
334F9152	11-27	345F1660A	01-56	349F0614	03-19
335F0088	05-44	345F1907A	07-69	349F0615	04-12
335F0088	06-11	345F1908	01-77	349F0616	04-18
335F0089	05-45	345F1909	01-75	350F2321	01-05
335F0089	06-13	345F1910	01-76	350F2338	12-27
335F0090	05-46	346F0980	06-37	350F2368	07-38
335F6791522	02-01	346F1812B	16-01	350F2948D	06-50
335F6791522	03-01	346F1813B	16-03	350F3020A	01-19
335F6791522	04-01	346F1815B	16-04	350F3026A	01-38
337F0025	02-37	346F1817	12-26	350F3028A	01-35
337F0025	03-32	346F2018	12-29	350F3075A	01-04
337F0025	04-34	346F2019A	08-28	350F3914	01-37
337F0026	02-38	346F2028	12-24	350F3915	01-48
337F0026	03-37	346F2049A	16-06	350F4062	12-02
337F0027	02-39	347F0704	02-26	350F4069A	10-10
337F0027	03-38	347F0704	03-15	350F4343A	12-07
337F0027	04-26	347F0704	04-16	350F4345	01-09
338F0234	05-60	347F0717A	01-51	350F4704	01-26
338F0234	06-21	347F0924	05-12	350F4709	13-24
338F0311	07-02	347F0924	05-51	350F4710	12-01
338F0311	07-10	347F0924	06-14	350F4712	15-09
338F0311	07-18	347F0924	06-35	350F4712	15-13



## FPM6000SP PART NO.INDEX LIST

Part No.	Index No.-Ref. No.	Part No.	Index No.-Ref. No.	Part No.	Index No.-Ref. No.
350F4713	15-01	356F8383A	13-27	369F0323A	10-16
350F4718A	14-02	356F8384	12-06	369F0361	07-52
350F4722	14-16	356F8389	13-17	369F0364C	12-16
350F4728	01-21	356F8390	13-29	369F0365	01-69
350F4728	01-45	356F8391	12-12	370FA001115	12-11
350F8362317	08-03	356F8392B	08-20	370FA002090	12-21
350F8395	14-40	356F8393	08-15	370FP001030	08-13
350H0096	01-①	356F8394A	12-25	370FP001200	08-12
350H0138	01-03	356F8397	14-13	370FY017	09-30
353F0273	14-24	356F8398	14-17	370S112E010	09-31
355F1325	01-08	356F8449B	08-27	370S116C020	09-32
356F10436	13-32	356F8759B	07-25	371F0277	09-20
356F10437	13-30	356F8777	08-24	371F0279	08-19
356F10438	13-34	356F8814	13-05	371F0545B	07-54
356F10439A	07-01	357H0029D	01-46	371F0546B	07-53
356F10439A	13-10	358F0375B	01-01	371F0591C	07-50
356F10440	13-31	358F0538	12-28	371F0595A	10-03
356F10441	13-07	358F0539B	15-11	371F0595A	10-39
356F3625	01-02	358F0539B	15-15	371F0595A	10-41
356F4882A	13-19	358F0540B	15-08	371F0595A	10-42
356F4889A	12-23	358F0541A	14-06	371F0596A	10-09
356F4894	13-08	361F1136	10-01	371F0596A	10-33
356F4895A	01-23	362F0657	01-49	371F0596A	10-35
356F4896	01-25	362F0660	01-36	371F0596A	10-36
356F4937C	11-04	362F1090	02-24	371F0647A	07-55
356F4938C	10-30	362F1090	03-23	371F0650B	07-58
356F4998E	11-22	362F1090	04-22	371F0663	07-51
356F5037A	01-58	362F1091	02-30	371F0663	09-28
356F6690A	10-48	362F1091	03-26	372F0067	08-10
356F6692	10-15	362F1091	04-24	372F0390A	08-11
356F7002	10-13	362F1142A	01-10	372F0531	09-27
356F7019A	10-11	362F1144	06-06	372F0549	08-16
356F7023A	01-70	363E3832A	07-32	372F0724	09-26
356F7682A	01-07	363F1609	05-10	372F0748A	09-06
356F7687B	08-05	363F2189	06-34	372F0748A	09-13
356F7692	10-04	363F2189	10-27	372F0748A	09-17
356F7693	10-07	363F2190	06-46	372F0748A	09-18
356F7695	01-68	363F2191	06-49	372F0783	08-25
356F7706	07-65	363F2251A-BF	01-24	372F0947	09-22
356F7708	07-16	363F2337A-BF	01-27	372F1230A	12-20
356F7709	07-40	363F2675-BF	10-28	372F1231B	09-12
356F7710	07-42	363F2872	05-38	372F1233	09-09
356F7728	01-44	363F3052	07-24	372F1237	09-21
356F7729A	01-18	363F3053A-BF	01-59	372F1238	09-02
356F7736A	12-14	363F3054	01-57	372F1239	09-11
356F7737A	12-15	363F3056	02-10	372F1240A	09-25
356F7738	01-15	363F3056	03-11	372F1243A	09-05
356F7742	12-10	363F3056	04-11	372F1244A	09-04
356F7746	11-17	363F3661	05-53	372F1245	08-14
356F7747A	11-02	363F3661	06-16	372F1257	09-23
356F7794A	12-30	363F3664	05-42	372F1259	09-16
356F7923	01-43	363F3664	06-01	372F1260	09-19
356F7939A	01-52	363F4380	06-03	372F1420	09-08
356F8348	01-22	367F0071	01-47	372F1461	09-14
356F8348	01-54	369F0214	01-42	372F1462	09-07

Part No.	Index No.-Ref. No.	Part No.	Index No.-Ref. No.	Part No.	Index No.-Ref. No.
372F1463	09-10	388F2146A	11-41	405F7368	10-40
372F1464	09-24	388F2147A	02-25	405F7369	10-08
372S0011A	09-29	388F2147A	03-06	405F7370	10-34
374F2010	08-17	388F2147A	03-24	405F7371	10-37
374F2142	08-23	388F2147A	04-06	405F7372	10-38
374F2168	08-09	388F2147A	04-23	405F7373A	12-18
374F2210	08-21	388F2147A	05-20	405F7374	01-63
374F2211	08-22	388F2147A	11-43	405F7429	13-23
375F0177	08-④	388F2148A	05-57	405F7430	13-22
375F0257A	08-30	388F2148A	06-19	405F7954	01-71
376F0116	13-01	388F2148A	06-43	405F7955	01-73
376F0116	14-22	388F2148A	11-39	405F8176	01-72
376F0180	07-34	388F2150A	02-13	405F8319222	01-32
376F0180	07-35	388F2150A	02-32	405F8319223	01-41
379H0022	08-06	388F2150A	03-30	405F8319224	01-31
379H0023	08-04	388F2150A	04-14	405F8319228	01-29
380H0061A	07-23	388F3084	02-27	405F8319228	01-39
380H0062A	07-22	388F3084	03-29	405F8319229	01-30
380H0063B	07-21	388F3084	04-27	405F8319229	01-40
380H0064A	07-57	388F3085	02-15	405F8319231	02-09
382F0046-M002	01-66	388F3085	03-14	405F8319232	03-09
382F0100-M002	12-19	388F3085	04-15	405F8319233	04-09
382F0130-M002	01-17	388F4019	06-04	405N0187	01-64
382F0424	07-31	394F0012	01-06	405S0061	01-34
382F0514	12-31	394F0050	01-33	405S0061	01-67
382F0516	12-32	405F0347	14-01	802H0181B	03-①
382F0516	12-34	405F0675	01-62	802H0182B	04-①
382F0517A	01-12	405F1110	11-29	802H0183A	05-①
382F0524	12-33	405F6944	01-13	802H0186A	06-②
387F0055	01-55	405F7345	01-65	802H0348	02-①
388F2146A	02-18	405F7346	01-74	802H0349	05-②
388F2146A	03-18	405F7365	10-02	802H0351	06-①
388F2146A	04-17	405F7366	10-44	857H0024E	13-①
388F2146A	05-32	405F7367	10-43		



**FUJIFILM**

**FUJI PHOTO FILM CO., LTD.**

26-30, Nishiazabu 2-chome, Minato-ku, Tokyo 106, Japan.

---